

# LISTA DE APLICACIONES - BUYERS GUIDE

## RB1194-117



Qty: 660

Weight: 11.160

O.E.M.	MAKE
190 6439	IVECO
299 2348	IVECO
299 2476	IVECO
299 5819	IVECO
299 5938	IVECO

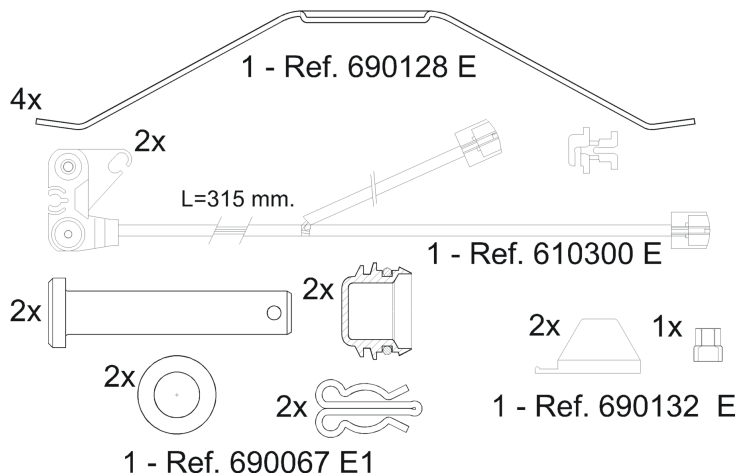
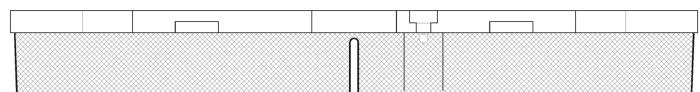
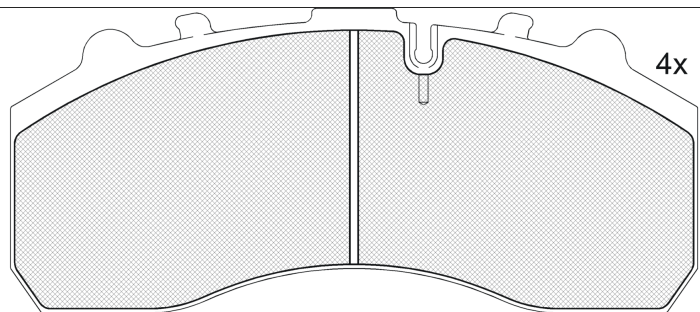

## RB1194-117



90R-01178/637



Knorr SB7000

247.5x109.6x30

WVA
29087
29105
29106
29108
29109

FMSI
D1203-8323

Sin Filas



Trac.	CC	Kw	CV
-------	----	----	----



Front / Rear

### IVECO

#### EuroCargo I-III 01.91-09.15

320 E 28 T tector (F4AE0681A)	Diesel	5883	202	275	09.00-09.15	*	*
-------------------------------	--------	------	-----	-----	-------------	---	---

#### EuroCargo I-III 01.91-09.15

180 E 21 tector (F4AE0681C)	Diesel		5883	154	209	09.00-09.15	*	*
180 E 21 tector (F4AE0681D)	Diesel		5883	154	209	09.00-09.15	*	*
180 E 24, 180 E 25 tector (F4AE0681B)	Diesel		5883	176	240	09.00-09.15	*	*
180 E 24, 180 E 25 tector (F4AE3681D)	Diesel		5883	176	240	09.00-09.15	*	*
180 E 28 tector, 180 E 28 P tector (F4AE0681A)	Diesel		5883	202	275	09.00-09.15	*	*
180 E 28 tector, 180 E 28 P tector (F4AE3681E)	Diesel		5883	202	275	09.00-09.15	*	*

#### EuroCargo I-III 01.91-09.15

170 E 15 K (8060.25R.4280)	Diesel		5861	105	143	12.91-07.00	*	
180 E 24 K tector (F4AE0681B)	Diesel		5883	176	240	09.00-09.15	*	*
180 E 28 K tector (F4AE0681A)	Diesel		5883	202	275	09.00-09.15	*	*
180 E 28 K tector (F4AE3681E)	Diesel		5883	202	275	09.00-09.15	*	*

#### EuroRider 01.92-

391.12.35	Diesel		11995			01.92-	*	*

#### EuroStar 01.93-10.02

LD 400 E 38 TX/P, LD 440 E 38 TX/P (8460.41L TCA)	Diesel		9498	276	375	01.93-02.02	*	
LD 400 E 38 TX/P, LD 440 E 38 TX/P (8460.41L.5020)	Diesel		9498	276	375	01.93-02.02	*	
LD 400 E 38 TX/P, LD 440 E 38 TX/P (8460.41N)	Diesel		9498	276	375	01.93-02.02	*	
LD 440 E 38 T (8460.41L TCA)	Diesel		9498	276	375	01.93-02.02	*	*
LD 440 E 38 T (8460.41N)	Diesel		9498	276	375	01.93-02.02	*	*

# LISTA DE APLICACIONES - BUYERS GUIDE

LD 440 E 38 TZ (8460.41L TCA)	Diesel	9498	276	375	01.93-02.02	*	*
LD 440 E 38 TZ (8460.41N)	Diesel	9498	276	375	01.93-02.02	*	*
LD 440 E 39 T, LD 440 E 39 T/P (F3AE0681E)	Diesel	10308	287	390	11.99-02.02	*	*
LD 440 E 39 TX, LD 440 E 39 TX/P (F3AE0681E)	Diesel	10308	287	390	11.99-10.02	*	
LD 440 E 40 T (F3AE0681B)	Diesel	10308	294	400	09.00-02.02	*	*
LD 440 E 40 TX/P (F3AE0681B)	Diesel	10308	294	400	01.01-02.02	*	*
LD 440 E 43 T/P (F3AE0681D)	Diesel	10308	316	430	01.93-02.02	*	*
LD 440 E 43 TX/P (F3AE0681D)	Diesel	10308	316	430	11.99-02.02	*	*
LD 440 E 48 T/P (F3BE0681E)	Diesel	12882	353	480	01.01-02.02	*	*
LD 400 E 42 TX/P, LD 440 E 42 TX/P (8210.42L.)	Diesel	13798	309	420	01.93-02.02	*	
LD 440 E 42 T/P (8210.42L(TCA))	Diesel	13798	309	420	01.93-02.02	*	*
LD 440 E 42 T/P (8210.42L.)	Diesel	13798	309	420	01.93-02.02	*	*
LD 440 E 42 TZ (8210.42L.)	Diesel	13798	309	420	01.93-02.02	*	*
LD 440 E 47 T/P (8210.42M. TCA)	Diesel	13798	345	469	01.93-02.02	*	*
LD 440 E 47 TZ (8210.42M. TCA)	Diesel	13798	345	469	01.93-02.02	*	*
LD 440 E 52 T (8280.42S. TCA)	Diesel	17173	378	514	01.93-02.02	*	*
LD 440 E 52 TZ (8280.42S. TCA)	Diesel	17173	378	514	01.93-02.02	*	*
<b>EuroStar 01.93-10.02</b>				<b>Caja/Chasis</b>			
LD 190 E 38 P (8460.41L TCA)	Diesel	9498	276	375	01.93-02.02	*	*
LD 240 E 38 (8460.41L.5020)	Diesel	9498	276	375	01.93-02.02	*	
LD 240 E 38	Diesel	9498	276	375	01.93-02.02	*	
LD 260 E 38 P (8460.41L TCA)	Diesel	9498	276	375	01.93-02.02	*	*
LD 190 E 39 P, LD 190 E 39 FP (F3AE0681E)	Diesel	10308	287	390	11.99-02.02	*	*
LD 260 E 39 P, LD 260 E 39 FP (F3AE0681E)	Diesel	10308	287	390	11.99-02.02	*	
LD 190 E 40 (F3AE0681B)	Diesel	10308	294	400	09.00-02.02	*	*
LD 260 E 40 (F3AE0681B)	Diesel	10308	294	400	09.00-02.02	*	
LD 260 E 40	Diesel	10308	294	400	09.00-02.02	*	
LD 190 E 43, LD 190 E 43 P, LD 190 E 43 FP (F3AE0681D)	Diesel	10308	316	430	11.99-02.02	*	*
LD 260 E 43 Y/PS, LD 260 E 43 FP (F3AE0681D)	Diesel	10308	316	430	01.93-02.02	*	*
LD 260 E 43 Y/PS, LD 260 E 43 FP	Diesel	10308	316	430	01.93-02.02	*	
LD 260 E 48 Y/PS (F3BE0681E)	Diesel	12882	353	480	01.93-02.02	*	
LD 190 E 42, LD 190 E 42 P (8210.42L(TCA))	Diesel	13798	309	420	01.93-02.02	*	*
LD 190 E 42, LD 190 E 42 P (8210.42L.400)	Diesel	13798	309	420	01.93-02.02	*	*
LD 240 E 42 FS, LD 240 E 42 PS (8210.42L(TCA))	Diesel	13798	309	420	01.93-02.02	*	
LD 240 E 42 FS, LD 240 E 42 PS (8210.42L.400)	Diesel	13798	309	420	01.93-02.02	*	
LD 240 E 42 FS, LD 240 E 42 PS	Diesel	13798	309	420	01.93-02.02	*	
LD 260 E 42 P (8210.42L.)	Diesel	13798	309	420	01.93-02.02	*	*
LD 190 E 47 (8210.42M. TCA)	Diesel	13798	345	469	01.93-02.02	*	*
LD 240 E 47 PS (8210.42M. TCA)	Diesel	13798	345	469	01.93-02.02	*	
LD 240 E 47 PS	Diesel	13798	345	469	01.93-02.02	*	
LD 260 E 47 (8210.42M. TCA)	Diesel	13798	345	469	01.93-02.02	*	*
LD 190 E 52 (8280.42S. TCA)	Diesel	17173	378	514	01.93-02.02	*	
LD 240 E 52 PS (8280.42S. TCA)	Diesel	17173	378	514	01.93-02.02	*	
LD 240 E 52 PS	Diesel	17173	378	514	01.93-02.02	*	
LD 260 E 52 (8280.42S. TCA)	Diesel	17173	378	514	01.93-02.02	*	*
<b>EuroTech MH 01.98-</b>				<b>Cabeza tractora</b>			
400 E 31 TP, 440 E 31 T, 440 E 31 TP (F2BE0681B)	Diesel	7790	228	310	09.98-	*	*
400 E 35 TP, 440 E 35 T, 440 E 35 T/P, 440 E 35 T/FP (F2BE0681A)	Diesel	7790	259	352	09.98-	*	*
440 E 35 TX/P (F2BE0681A)	Diesel	7790	259	352	02.00-	*	

# LISTA DE APLICACIONES - BUYERS GUIDE

EuroTech MH 01.98-					Caja/Chasis				
190 E 24, 190 E 24 /P (F2BE0681D)	Diesel		7790	180	245	09.98-	*	*	
260 E 24 Y/P, 260 E 24 Y/PS, 260 E 24 Y/PT (F2BE0681D)	Diesel		7790	180	245	11.99-	*	*	
260 E 24 Y/P, 260 E 24 Y/PS, 260 E 24 Y/PT	Diesel		7790	180	245	11.99-	*		
190 E 27, 190 E 27 /P (F2BE0681C)	Diesel		7790	200	272	09.98-	*	*	
190 E 27, 190 E 27 /P (F2BE0681F)	Diesel		7790	200	272	09.98-	*	*	
260 E 27 Y/P, 260 E 27 Y/PS, 260 E 27 RY/PS, 260 E 27 RY/PT (F2BE0681C)	Diesel		7790	200	272	11.99-	*	*	
260 E 27 Y/P, 260 E 27 Y/PS, 260 E 27 RY/PS, 260 E 27 RY/PT (F2BE0681F)	Diesel		7790	200	272	11.99-	*	*	
260 E 27 Y/P, 260 E 27 Y/PS, 260 E 27 RY/PS, 260 E 27 RY/PT	Diesel		7790	200	272	11.99-	*		
190 E 30, 190 E 30 /P (F2BE0681E)	Diesel		7790	218	296	01.00-	*		
260 E 30 Y/PS (F2BE0681E)	Diesel		7790	218	296	01.00-	*		
260 E 30 Y/PS	Diesel		7790	218	296	01.00-	*		
190 E 31, 190 E 31 /P (F2BE0681B)	Diesel		7790	228	310	09.98-	*	*	
260 E 31 Y/P, 260 E 31 Y/PS, 260 E 31 Y/PT (F2BE0681B)	Diesel		7790	228	310	11.99-	*	*	
260 E 31 Y/P, 260 E 31 Y/PS, 260 E 31 Y/PT	Diesel		7790	228	310	11.99-	*		
190 E 35, 190 E 35 /P, 190 E 35 /FP (F2BE0681A)	Diesel		7790	259	352	09.98-	*	*	
260 E 35 Y/P, 260 E 35 Y/PT, 260 E 35 Y/TN (F2BE0681A)	Diesel		7790	259	352	11.99-	*	*	
260 E 35 Y/P, 260 E 35 Y/PT, 260 E 35 Y/TN	Diesel		7790	259	352	11.99-	*		
EuroTech MH 01.98-					Camión volquete				
190 E 24 K (F2BE0681D)	Diesel		7790	180	245	09.98-	*	*	
190 E 27 K (F2BE0681C)	Diesel		7790	200	272	09.98-	*	*	
190 E 27 K (F2BE0681F)	Diesel		7790	200	272	09.98-	*	*	
190 E 31 K (F2BE0681B)	Diesel		7790	228	310	09.98-	*	*	
EuroTech MP 01.92-					Cabeza tractora				
400 E 34 T, 440 E 34 T (8460.41K.406)	Diesel		9498	254	345	01.92-	*		
400 E 38 T, 440 E 38 T, 440 E 38 T /P (8460.41L.5020)	Diesel		9498	276	375	01.92-	*		
400 E 38 T, 440 E 38 T, 440 E 38 T /P (8460.41N)	Diesel		9498	276	375	01.92-	*		
400 E 38 TXP (8460.41L.5020)	Diesel		9498	276	375	11.93-12.96	*		
400 E 38 TXP (8460.41N)	Diesel		9498	276	375	11.93-12.96	*		
440 E 38 TZ (8460.41L TCA)	Diesel		9498	276	375	01.93-	*	*	
440 E 39 T, 440 E 39 T/P, 440 E 39 T/FP-CT (F3AE0681E)	Diesel		10308	287	390	11.99-	*		
440 E 39 TX/P (F3AE0681E)	Diesel		10308	287	390	11.99-	*		
440 E 40 T/P (F3AE0681B)	Diesel		10308	294	400	09.00-	*		
440 E 40 TX/P (F3AE0681B)	Diesel		10308	294	400	01.01-	*		
440 E 43 T, 440 E 43 T/P (F3AE0681D)	Diesel		10308	316	430	11.99-	*		
440 E 43 TX/P (F3AE0681D)	Diesel		10308	316	430	11.99-	*		
400 E 42 T, 440 E 42 T, 440 E 42 T/P (8210.42L (TCA))	Diesel		13798	309	420	01.92-	*		
400 E 42 T, 440 E 42 T, 440 E 42 T/P (8210.42L.400)	Diesel		13798	309	420	01.92-	*		
440 E 42 TZ (8210.42L.400)	Diesel		13798	309	420	01.93-	*	*	
EuroTech MP 01.92-					Caja/Chasis				
240 E 30 PS (8460.41C. TCA)	Diesel		9498	221	301	01.97-	*		
180 E 34 (8460.41K.406)	Diesel		9498	254	345	01.92-12.93	*		
190 E 34 (8460.41K.406)	Diesel		9498	254	345	01.93-	*		
240 E 34 (8460.41K. TCA)	Diesel		9498	254	345	09.95-12.96	*		
180 E 38 (8460.41L.5020)	Diesel		9498	276	375	01.92-12.93	*		

# LISTA DE APLICACIONES - BUYERS GUIDE

190 E 38 (8460.41L TCA)	Diesel	9498	276	375	01.93-	*
240 E 38 (8460.41L.5020)	Diesel	9498	276	375	01.92-	*
240 E 38	Diesel	9498	276	375	01.92-	*
260 E 38 P (8460.41N)	Diesel	9498	276	375	01.94-	*
190 E 39, 190 E 39 /P, 190 E39 /FP (F3AE0681E)	Diesel	10308	287	390	11.99-	*
260 E 39 Y, 260 E 39 Y/P, 260 E 39 Y/FP, 260 E 39 Y/FS (F3AE0681E)	Diesel	10308	287	390	11.99-	*
190 E 40 /P (F3AE0681B)	Diesel	10308	294	400	01.01-	*
260 E 40 (F3AE0681B)	Diesel	10308	294	400	01.01-	*
260 E 40	Diesel	10308	294	400	01.01-	*
190 E 43, 190 E 43 /P (F3AE0681D)	Diesel	10308	316	430	01.01-	*
260 E 43 Y, 260 E 43 Y/P (F3AE0681D)	Diesel	10308	316	430	11.99-	*
180 E 42 (8210.42L.400)	Diesel	13798	309	420	01.92-12.93	*
190 E 42, 190 E 42 /P (8210.42L.400)	Diesel	13798	309	420	01.93-	*
240 E 42 (8210.42L.400)	Diesel	13798	309	420	01.92-	*
240 E 42	Diesel	13798	309	420	01.92-	*
260 E 42 (8210.42L.400)	Diesel	13798	309	420	01.94-	*
<b>EuroTech MT 01.92-08.98</b>			<b>Cabeza tractora</b>			
400 E 30 T (8460.41C.320)	Diesel	9498	221	301	01.92-08.98	* *
400 E 34 T (8460.41K.406)	Diesel	9498	254	345	01.92-08.98	* *
<b>EuroTech MT 01.92-08.98</b>			<b>Caja/Chasis</b>			
180 E 24 (8360.46R.416 TCA)	Diesel	7685	176	239	01.92-12.96	* *
190 E 24 (8360.46R.416 TCA)	Diesel	7685	176	239	01.97-08.98	* *
180 E 27 (8360.46.417 TCA)	Diesel	7685	196	267	01.92-12.96	* *
190 E 27 (8360.46.417 TCA)	Diesel	7685	196	267	01.97-08.98	* *
180 E 30 R (8460.41C.320)	Diesel	9498	221	301	01.92-12.96	* *
190 E 30 (8460.41C.320)	Diesel	9498	221	301	01.97-08.98	* *
180 E 34 R (8460.41K.406)	Diesel	9498	254	345	01.92-12.93	* *
<b>EuroTech MT 01.92-08.98</b>			<b>Camión volquete</b>			
180 E 24 K (8360.46R.416 TCA)	Diesel	7685	176	239	01.93-12.96	* *
190 E 24 K (8360.46R.416 TCA)	Diesel	7685	176	239	01.97-08.98	* *
180 E 27 K (8360.46.417 TCA)	Diesel	7685	196	267	01.92-12.96	* *
190 E 27 K (8360.46.417 TCA)	Diesel	7685	196	267	01.97-08.98	* *
190 E 30 K (8460.41C.320)	Diesel	9498	221	301	01.97-08.98	* *
<b>EuroTrakker 01.93-12.06</b>			<b>Cabeza tractora</b>			
MP 400 E 34 HT (8460.41K.)	Diesel	9498	254	345	01.93-11.04	* *
MP 400 E 34 HT (8460.41K. TCA)	Diesel	9498	254	345	01.93-11.04	* *
MP 440 E 34 HT (8460.41K.)	Diesel	9498	254	345	01.93-11.04	* *
MP 440 E 34 HT (8460.41K. TCA)	Diesel	9498	254	345	01.93-11.04	* *
MP 400 E 37 HT (8210.42K(TCA))	Diesel	13798	272	370	01.93-11.04	* *
MP 400 E 37 HT (8210.42K.)	Diesel	13798	272	370	01.93-11.04	* *
MP 400 E 37 WT (8210.42K(TCA))	Diesel	13798	272	370	01.93-11.04	* *
MP 400 E 37 WT (8210.42K.)	Diesel	13798	272	370	01.93-11.04	* *
MP 440 E 37 HT (8210.42K(TCA))	Diesel	13798	272	370	01.93-11.04	* *
MP 440 E 37 HT (8210.42K.)	Diesel	13798	272	370	01.93-11.04	* *
MP 720 E 37 HT (8210.42K(TCA))	Diesel	13798	272	370	01.93-11.04	* *
MP 720 E 37 HT (8210.42K.)	Diesel	13798	272	370	01.93-11.04	* *
MP 720 E 37 WT (8210.42K(TCA))	Diesel	13798	272	370	01.93-11.04	* *
MP 720 E 37 WT (8210.42K.)	Diesel	13798	272	370	01.93-11.04	* *
MP 400 E 42 HT (8210.42L(TCA))	Diesel	13798	309	420	01.93-11.04	* *

# LISTA DE APLICACIONES - BUYERS GUIDE

MP 400 E 42 HT (8210.42L.)		Diesel		13798	309	420	01.93-11.04	*	*
MP 400 E 42 WT (8210.42L(TCA))		Diesel		13798	309	420	01.93-11.04	*	*
MP 400 E 42 WT (8210.42L.)		Diesel		13798	309	420	01.93-11.04	*	*
MP 440 E 42 HT (8210.42L(TCA))		Diesel		13798	309	420	01.93-11.04	*	*
MP 440 E 42 HT (8210.42L.)		Diesel		13798	309	420	01.93-11.04	*	*
MP 720 E 42 HT (8210.42L(TCA))		Diesel		13798	309	420	01.93-11.04	*	*
MP 720 E 42 HT (8210.42L.)		Diesel		13798	309	420	01.93-11.04	*	*
MP 720 E 42 WT (8210.42L(TCA))		Diesel		13798	309	420	01.93-11.04	*	*
MP 720 E 42 WT (8210.42L.)		Diesel		13798	309	420	01.93-11.04	*	*
MP 720 E 47 HT (8210.42M. TCA)		Diesel		13798	345	469	01.93-11.04	*	*
<b>EuroTrakker 01.93-12.06</b>					<b>Caja/Chasis</b>				
MP 190 E 31 H Cursor (F2BE0681B)		Diesel		7790	228	310	09.99-11.04	*	*
MP 190 E 31 W Cursor (F2BE0681B)		Diesel		7790	228	310	09.99-11.04	*	*
MP 260 E 31 H Cursor (F2BE0681B)		Diesel		7790	228	310	09.99-11.04	*	*
MP 190 E 35 H Cursor (F2BE0681A)		Diesel		7790	259	352	09.99-11.04	*	*
MP 190 E 35 W Cursor (F2BE0681A)		Diesel		7790	259	352	09.99-11.04	*	*
MP 260 E 35 H Cursor (F2BE0681A)		Diesel		7790	259	352	01.00-11.04	*	*
MP 260 E 35 W Cursor (F2BE0681A)		Diesel		7790	259	352	09.99-11.04	*	*
MP 340 E 35 H Cursor (F2BE0681A)		Diesel		7790	259	352	09.99-11.04	*	*
MP 190 E 38 W Cursor (F3BE0681G)		Diesel		12882	280	380	01.01-11.04	*	*
MP 260 E 38 H Cursor (F3BE0681G)		Diesel		12882	280	380	01.01-11.04	*	*
MP 260 E 38 W Cursor (F3BE0681G)		Diesel		12882	280	380	01.01-11.04	*	*
MP 340 E 38 H Cursor (F3BE0681G)		Diesel		12882	280	380	01.01-11.04	*	*
MP 380 E 38 H Cursor (F3BE0681G)		Diesel		12882	280	380	01.01-11.04	*	*
MP 380 E 38 W Cursor (F3BE0681G)		Diesel		12882	280	380	01.01-11.04	*	*
MP 410 E 38 H Cursor (F3BE0681G)		Diesel		12882	280	380	01.01-11.04	*	*
MP 190 E 44 W Cursor (F3BE0681C)		Diesel		12882	324	440	09.00-11.04	*	*
MP 260 E 44 H Cursor (F3BE0681C)		Diesel		12882	324	440	01.00-11.04	*	*
MP 260 E 44 W Cursor (F3BE0681C)		Diesel		12882	324	440	01.01-11.04	*	*
MP 340 E 44 H Cursor (F3BE0681C)		Diesel		12882	324	440	01.01-11.04	*	*
MP 380 E 44 H Cursor (F3BE0681C)		Diesel		12882	324	440	01.01-11.04	*	*
MP 380 E 44 W Cursor (F3BE0681C)		Diesel		12882	324	440	01.01-11.04	*	*
MP 410 E 42 W (8210.42L(TCA))		Diesel		13798	309	420	01.93-11.04	*	*
MP 410 E 42 W (8210.42L.)		Diesel		13798	309	420	01.93-11.04	*	*
<b>EuroTrakker 01.93-12.06</b>					<b>Camión volquete</b>				
MP 190 E 31 H Cursor (F2BE0681B)		Diesel		7790	228	310	09.99-11.04	*	*
MP 190 E 31 W Cursor (F2BE0681B)		Diesel		7790	228	310	09.99-11.04	*	*
MP 260 E 31 H Cursor (F2BE0681B)		Diesel		7790	228	310	09.99-11.04	*	*
MP 190 E 35 H Cursor (F2BE0681A)		Diesel		7790	259	352	09.99-11.04	*	*
MP 190 E 35 W Cursor (F2BE0681A)		Diesel		7790	259	352	09.99-11.04	*	*
MP 260 E 35 H Cursor (F2BE0681A)		Diesel		7790	259	352	01.00-11.04	*	*
MP 260 E 35 W Cursor (F2BE0681A)		Diesel		7790	259	352	09.99-11.04	*	*
MP 340 E 35 H Cursor (F2BE0681A)		Diesel		7790	259	352	09.99-11.04	*	*
MP 190 E 30 H (8460.41C.)		Diesel		9498	221	301	01.93-11.04	*	*
MP 190 E 30 W (8460.41C.)		Diesel		9498	221	301	01.93-11.04	*	*
MP 260 E 30 H (8460.41C.)		Diesel		9498	221	301	01.93-11.04	*	*
MP 190 E 34 H (8460.41K.)		Diesel		9498	254	345	01.93-11.04	*	*
MP 190 E 34 W (8460.41K.)		Diesel		9498	254	345	01.93-11.04	*	*
MP 260 E 34 H (8460.41K.)		Diesel		9498	254	345	01.93-11.04	*	*
MP 260 E 34 W (8460.41K.)		Diesel		9498	254	345	01.93-11.04	*	*
MP 340 E 34 H (8460.41K.)		Diesel		9498	254	345	01.93-11.04	*	*

# LISTA DE APLICACIONES - BUYERS GUIDE

MP 380 E 34 H (8460.41K.)		Diesel		9498	254	345	01.93-11.04	*	*
MP 190 E 38 W Cursor (F3BE0681G)		Diesel		12882	280	380	01.01-11.04	*	*
MP 260 E 38 H Cursor (F3BE0681G)		Diesel		12882	280	380	01.01-11.04	*	*
MP 260 E 38 W Cursor (F3BE0681G)		Diesel		12882	280	380	01.01-11.04	*	*
MP 340 E 38 H Cursor (F3BE0681G)		Diesel		12882	280	380	01.01-11.04	*	*
MP 380 E 38 H Cursor (F3BE0681G)		Diesel		12882	280	380	01.01-11.04	*	*
MP 380 E 38 W Cursor (F3BE0681G)		Diesel		12882	280	380	01.01-11.04	*	*
MP 410 E 38 H Cursor (F3BE0681G)		Diesel		12882	280	380	01.01-11.04	*	*
MP 190 E 44 W Cursor (F3BE0681C)		Diesel		12882	324	440	09.00-11.04	*	*
MP 260 E 44 H Cursor (F3BE0681C)		Diesel		12882	324	440	01.01-11.04	*	*
MP 260 E 44 W Cursor (F3BE0681C)		Diesel		12882	324	440	01.01-11.04	*	*
MP 340 E 44 H Cursor (F3BE0681C)		Diesel		12882	324	440	01.01-11.04	*	*
MP 380 E 44 H Cursor (F3BE0681C)		Diesel		12882	324	440	01.01-11.04	*	*
MP 380 E 44 W Cursor (F3BE0681C)		Diesel		12882	324	440	01.01-11.04	*	*
MP 410 E 44 H Cursor (F3BE0681C)		Diesel		12882	324	440	01.01-11.04	*	*
MP 190 E 37 H (8210.42K.)		Diesel		13798	272	370	01.93-11.04	*	*
MP 190 E 37 W (8210.42K.)		Diesel		13798	272	370	01.93-11.04	*	*
MP 260 E 37 H (8210.42K.)		Diesel		13798	272	370	01.93-11.04	*	*
MP 260 E 37 W (8210.42K.)		Diesel		13798	272	370	01.93-11.04	*	*
MP 340 E 37 H (8210.42K.)		Diesel		13798	272	370	01.93-11.04	*	*
MP 380 E 37 H (8210.42K.)		Diesel		13798	272	370	01.93-11.04	*	*
MP 380 E 37 W (8210.42K.)		Diesel		13798	272	370	01.93-11.04	*	*
MP 410 E 37 H (8210.42K.)		Diesel		13798	272	370	01.93-11.04	*	*
MP 190 E 42 H (8210.42L.)		Diesel		13798	309	420	01.93-11.04	*	*
MP 190 E 42 W (8210.42L(TCA))		Diesel		13798	309	420	01.93-11.04	*	*
MP 190 E 42 W (8210.42L.)		Diesel		13798	309	420	01.93-11.04	*	*
MP 260 E 42 H (8210.42L.)		Diesel		13798	309	420	01.93-11.04	*	*
MP 260 E 42 W (8210.42L(TCA))		Diesel		13798	309	420	01.93-11.04	*	*
MP 260 E 42 W (8210.42L.)		Diesel		13798	309	420	01.93-11.04	*	*
MP 340 E 42 H (8210.42L.)		Diesel		13798	309	420	01.93-11.04	*	*
MP 380 E 42 H (8210.42L.)		Diesel		13798	309	420	01.93-11.04	*	*
MP 380 E 42 W (8210.42L.)		Diesel		13798	309	420	01.93-11.04	*	*
MP 410 E 42 H (8210.42L.)		Diesel		13798	309	420	01.93-11.04	*	*
<b>EuroTrakker 01.93-12.06</b>					<b>Hormigonera</b>				
MP 260 E 31 HB Cursor (F2BE0681B)		Diesel		7790	228	310	11.99-11.04	*	*
MP 340 E 35 HB Cursor (F2BE0681A)		Diesel		7790	259	352	01.01-11.04	*	*
MP 340 E 38 HB Cursor (F3BE0681G)		Diesel		12882	280	380	01.01-11.04	*	*
MP 340 E 44 HB Cursor (F3BE0681C)		Diesel		12882	324	440	01.01-11.04	*	*
<b>Stralis 02.02-</b>					<b>Cabeza tractora</b>				
AD 440S35, AT 440S35, AD 440S36, AT 440S36 (F2BE0681A)		Diesel		7790	259	352	06.03-	*	*
AD 440S35, AT 440S35, AD 440S36, AT 440S36 (F2BE3681A)		Diesel		7790	259	352	06.03-	*	*
AD 440S40, AT 440S40 (F3AE0681B)		Diesel		10308	294	400	06.03-	*	*
AD 440S40, AT 440S40 (F3AE0681H)		Diesel		10308	294	400	06.03-	*	*
AD 440S40, AT 440S40 (F3AE0681B)		Diesel		10308	294	400	06.03-	*	*
AS 440S40 (F3AE0681B)		Diesel		10308	294	400	02.02-	*	*
AS 440S40 (F3AE0681H)		Diesel		10308	294	400	02.02-	*	*
AS 440S40 (F3AE0681B)		Diesel		10308	294	400	02.02-	*	*
AD 440S43, AT 440S43 (F3AE0681D)		Diesel		10308	316	430	06.03-	*	*
AD 440S43, AT 440S43 (F3AE0681D)		Diesel		10308	316	430	06.03-	*	*
AS 440S43 (F3AE0681D)		Diesel		10308	316	430	02.02-	*	*

# LISTA DE APLICACIONES - BUYERS GUIDE

AS 440S43 (F3AE0681D)		Diesel		10308	316	430	02.02-	*	*
AT 440S43 (F3AE0681D)		Diesel		10308	316	430	06.03-	*	*
AS 440S46		Diesel		10308	338	460	12.09-	*	
AS 440S54, ES 440S54 (F3BE0681A)		Diesel		12880	397	540	02.02-	*	*
AS 440S48 (F3BE0681E)		Diesel		12882	353	480	02.02-	*	*
AS 440S48 (F3BE0681E)		Diesel		12882	353	480	02.02-	*	*
AS 440S48 (F3BE0681E)		Diesel		12882	353	480	02.02-	*	*
AS 440S54 (F3BE0681A)		Diesel		12882	397	540	02.02-	*	*
AS 440S54 (F3BE0681A)		Diesel		12882	397	540	02.02-	*	*
<b>Stralis 02.02-</b>					<b>Cabeza tractora</b>				
AT 440S33 CNG (F2GE0682A)		Gasolina		7790	243	330	01.13-	*	
<b>Stralis 02.02-</b>					<b>Caja/Chasis</b>				
AD 190S30, AD 190S31, AT 190S31 (F2BE0681B)		Diesel		7790	218	296	06.03-	*	*
AD 190S30, AD 190S31, AT 190S31 (F2BE0681E)		Diesel		7790	218	296	06.03-	*	*
AD 190S30, AD 190S31, AT 190S31 (F2BE3681C)		Diesel		7790	218	296	06.03-	*	*
AD 260S31, AT 260S31 (F2BE0681B)		Diesel		7790	228	310	06.03-	*	*
AD 260S31, AT 260S31 (F2BE3681C)		Diesel		7790	228	310	06.03-	*	*
AD 260S31, AT 260S31		Diesel		7790	228	310	06.03-	*	
AD 260S33, AT 260S33		Diesel		7790	243	330	12.06-	*	
AD 190S35, AT 190S35, AD 190S36, AT 190S36 (F2BE0681A)		Diesel		7790	259	352	06.03-	*	*
AD 190S35, AT 190S35, AD 190S36, AT 190S36 (F2BE3681A)		Diesel		7790	259	352	06.03-	*	*
AD 260S35, AT 260S35, AD 260S36, AT 260S36 (F2BE0681A)		Diesel		7790	259	352	06.03-	*	*
AD 260S35, AT 260S35, AD 260S36, AT 260S36 (F2BE3681A)		Diesel		7790	259	352	06.03-	*	*
AD 260S35, AT 260S35, AD 260S36, AT 260S36		Diesel		7790	259	352	06.03-	*	
AS 260S43 (F3AE0681D)		Diesel		10300	316	430	02.02-	*	*
AD 190S40, AT 190S40 (F3AE0681B)		Diesel		10308	294	400	03.03-	*	*
AD 190S40, AT 190S40 (F3AE0681H)		Diesel		10308	294	400	03.03-	*	*
AD 260S40, AT 260S40 (F3AE0681B)		Diesel		10308	294	400	06.03-	*	*
AD 260S40, AT 260S40 (F3AE0681H)		Diesel		10308	294	400	06.03-	*	*
AD 260S40, AT 260S40		Diesel		10308	294	400	06.03-	*	
AS 190S40 (F3AE0681B)		Diesel		10308	294	400	02.02-	*	*
AS 190S40 (F3AE0681H)		Diesel		10308	294	400	02.02-	*	*
AS 260S40 (F3AE0681B)		Diesel		10308	294	400	02.02-	*	*
AS 260S40 (F3AE0681H)		Diesel		10308	294	400	02.02-	*	*
AS 260S40		Diesel		10308	294	400	02.02-	*	
AD 260S42, AT 260S42 (F3AE3681B)		Diesel		10308	310	422	12.06-	*	
AD 260S42, AT 260S42, AS 260S42		Diesel		10308	310	422	05.07-	*	
AD 190S43, AT 190S43 (F3AE0681D)		Diesel		10308	316	430	06.03-	*	*
AD 260S43, AT 260S43 (F3AE0681D)		Diesel		10308	316	430	06.03-	*	*
AD 260S43, AT 260S43		Diesel		10308	316	430	06.03-	*	
AS 190S43 (F3AE0681D)		Diesel		10308	316	430	02.02-	*	*
AS 260S43		Diesel		10308	316	430	02.02-	*	
AD 260S45, AT 260S45, AS 260S45		Diesel		10308	331	450	05.07-	*	
AS 260S48, AT260S48 (F3BE0681E)		Diesel		12880	353	480	02.02-	*	*
AS 190S48 (F3BE0681E)		Diesel		12882	353	480	02.02-	*	*
AS 260S48 (F3BE0681E)		Diesel		12882	353	480	02.02-	*	*
AS 260S48		Diesel		12882	353	480	02.02-	*	
AS 260S54 (F3BE0681A)		Diesel		12882	397	540	02.02-	*	*
AS 260S54 (F3BE0681A)		Diesel		12882	397	540	02.02-	*	*

# LISTA DE APLICACIONES - BUYERS GUIDE

Stralis 02.02-					Caja/Chasis			
AD 260S27 CNG, AT 260S27 CNG	Gasolina		7790	200	272	01.08-	*	
AD 260S30 CNG (F2GE0682A)	Gasolina		7790	220	299	01.13-	*	
Stralis 02.02-					Veh. Municipal			
AD 260S27, AT 260S27	Diesel		7790	200	272	04.04-	*	
AD 260S30, AT 260S30	Diesel		7790	218	296	04.04-	*	
AD 260S31, AT 260S31	Diesel		7790	228	310	04.04-	*	
AD 260S33, AT 260S33	Diesel		7790	243	330	06.07-	*	
AD 260S36, AT 260S36	Diesel		7790	265	360	07.07-	*	
Tector II 08.12-12.18					Cabeza tractora			
170E28 (F4AE3681E)	Diesel		5883	206	280	09.12-	*	
Tector II 08.12-12.18					Caja/Chasis			
150E21 (F4AFE411C)	Diesel		4485	150	204	01.12-	*	
170E22 (F4AE3681B)	Diesel		5883	160	218	01.12-	*	
170E28 (F4AE3681E)	Diesel		5883	206	280	01.12-	*	
240E28 (F4AE3681E)	Diesel		5883	206	280	01.12-	*	
Trakker 09.04-					Cabeza tractora			
AD 400T41 WT, AT 400T41 WT (F3BE3681D)	Diesel		12882	302	410	03.06-12.12	* *	
AD 400T45 WT, AT 400T45 WT (F3BE3681C)	Diesel		12882	332	450	03.06-12.12	* *	
Trakker 09.04-					Caja/Chasis			
AD 180T27 W, AT 180T27 W (F2BE0681F)	Diesel		7790	200	272	06.05-10.07	* *	
AD 190T31, AT 190T31 (F2BE0681B)	Diesel		7790	228	310	10.04-10.07	*	
AD 190T31 W, AT 190T31 W (F2BE0681B)	Diesel		7790	228	310	06.05-10.07	* *	
AD 190T31 W, AT 190T31 W (F2BE3681C)	Diesel		7790	228	310	06.05-10.07	* *	
AD 190T33 W, AT 190T33 W (F2BE3681B)	Diesel		7790	243	330	03.06-12.12	* *	
AD 260T36 W, AD 380T36 W, AT 260T36 W, AT 380T36 W (F2BE3681A)	Diesel		7790	265	360	10.04-12.12	* *	
AD 260T38, AD 260T38 /P, AT 260T38 (F3BE0681G)	Diesel		12882	280	380	06.05-10.07	*	
AD 260T41 W, AD 380T41 W, AT 260T41 W, AT 380T41 W (F3BE3681D)	Diesel		12882	302	410	03.06-12.12	* *	
AD 260T44, AD 260T44 /P, AT 260T44 (F3BE0681C)	Diesel		12882	324	440	06.05-10.07	*	
AD 260T45 W, AD 380T45 W, AT 260T45 W, AT 380T45 W (F3BE3681C)	Diesel		12882	332	450	03.06-12.12	* *	
AD 410T45 W (F3BE3681C)	Diesel		12882	332	450	03.06-12.12	* *	
Trakker 09.04-					Camión volquete			
AD 190T31, AT 190T31 (F2BE0681B)	Diesel		7790	228	310	10.04-10.07	*	
AD 190T31 W, AT 190T31 W (F2BE0681B)	Diesel		7790	228	310	10.04-12.12	*	
AD 260T31, AT 260T31 (F2BE0681B)	Diesel		7790	228	310	10.04-	*	
AD 190T35, AD 190T36, AT 190T35, AT 190T36 (F2BE0681A)	Diesel		7790	259	352	10.04-12.12	*	
AD 190T35, AD 190T36, AT 190T35, AT 190T36 (F2BE3681A)	Diesel		7790	259	352	10.04-12.12	*	
AD 190T35 W, AD 190T36 W, AT 190T35 W, AT 190T36 W (F2BE0681A)	Diesel		7790	259	352	10.04-10.07	*	
AD 190T35 W, AD 190T36 W, AT 190T35 W, AT 190T36 W (F2BE3681A)	Diesel		7790	259	352	10.04-10.07	*	
AD 260T35, 260T36, 380T36, AT 260T35, 260T36, 380T36 (F2BE0681A)	Diesel		7790	259	352	10.04-12.12	*	
AD 260T35, 260T36, 380T36, AT 260T35, 260T36, 380T36 (F2BE3681A)	Diesel		7790	259	352	10.04-12.12	*	
AD 190T38, AT 190T38 (F3BE0681G)	Diesel		12882	280	380	10.04-12.12	*	
AD 190T38 W, AT 190T38 W (F3BE0681G)	Diesel		12882	280	380	10.04-10.07	*	
AD 260T38 , AT 260T38 (F3BE0681G)	Diesel		12882	280	380	10.04-	*	



# LISTA DE APLICACIONES - BUYERS GUIDE

AD 190T44, AD 190T45, AT 190T44, AT 190T45 (F3BE0681C)	Diesel		12882	324	440	10.04-12.12	*
AD 190T44, AD 190T45, AT 190T44, AT 190T45 (F3BE3681C)	Diesel		12882	324	440	10.04-12.12	*
AD 190T44 W, AD 190T45 W, AT 190T44 W, AD 190T45W (F3BE0681C)	Diesel		12882	324	440	10.04-12.12	*
AD 190T44 W, AD 190T45 W, AT 190T44 W, AD 190T45W (F3BE3681C)	Diesel		12882	324	440	10.04-12.12	*
<b>Zeta 01.79-12.92</b>				<b>Bus</b>			
A 60-9 (8040.05.200)	Diesel		3908	65	88	09.88-12.92	*
A 60-9 (8040.05.203)	Diesel		3908	65	88	09.88-12.92	*
A 70-12 (8340.05.200)	Diesel		5401	84	114	01.83-01.85	*
A 70-14 (8060.05.246)	Diesel		5861	101	137	05.88-12.92	*
A 70-14 (8060.05.285)	Diesel		5861	101	137	05.88-12.92	*