

# LISTA DE APLICACIONES - BUYERS GUIDE

## 78RBD24022



Weight: 13.564

| O.E.M.        | MAKE    |
|---------------|---------|
| 40 20 600 10R | RENAULT |
| 40 20 641 51R | RENAULT |

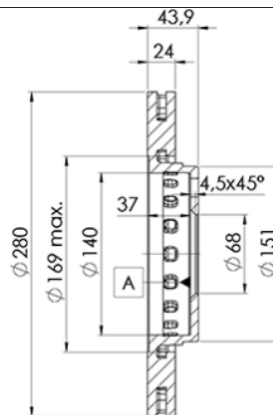
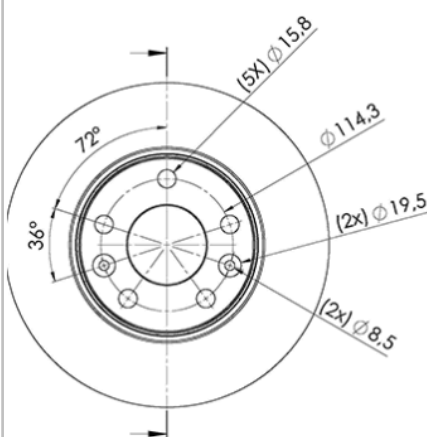

## 78RBD24022



Ø280x24x43.9

Sin Filas



| Trac. | CC | Kw | CV |
|-------|----|----|----|
|-------|----|----|----|



Front / Rear

### DACIA

| DUSTER 04.11-                    |          |     |      |    | Furgoneta/SUV (Compact SUV-J Segment) |             |   |  |
|----------------------------------|----------|-----|------|----|---------------------------------------|-------------|---|--|
| 1.2 TCe 125 4x4 (HSAU) (H5F 404) | Gasolina | 4WD | 1197 | 92 | 125                                   | 10.13-      | * |  |
| 1.6 16V                          | Gasolina | FWD | 1598 | 77 | 105                                   | 04.11-      | * |  |
| 1.6 SCe 115                      | Gasolina | FWD | 1598 | 84 | 115                                   | 06.15-      | * |  |
| 1.6 SCe 115 4x4                  | Gasolina | 4WD | 1598 | 84 | 115                                   | 06.15-01.18 | * |  |
| 1.5 dCi (K9K 884)                | Diesel   | FWD | 1461 | 66 | 90                                    | 04.11-      | * |  |
| 1.5 dCi (K9K 892)                | Diesel   | FWD | 1461 | 66 | 90                                    | 04.11-      | * |  |
| 1.5 dCi 4x4 (K9K 884)            | Diesel   | 4WD | 1461 | 66 | 90                                    | 04.11-      | * |  |
| 1.5 dCi 4x4 (K9K 892)            | Diesel   | 4WD | 1461 | 66 | 90                                    | 04.11-      | * |  |
| 1.5 dCi (K9K 666)                | Diesel   | FWD | 1461 | 80 | 109                                   | 04.13-      | * |  |
| 1.5 dCi (K9K 856)                | Diesel   | FWD | 1461 | 80 | 109                                   | 04.13-      | * |  |
| 1.5 dCi 4x4 (K9K 658)            | Diesel   | 4WD | 1461 | 80 | 109                                   | 04.13-      | * |  |
| 1.5 dCi 4x4 (K9K 858)            | Diesel   | 4WD | 1461 | 80 | 109                                   | 04.13-      | * |  |
| DUSTER (HS_) 04.10-              |          |     |      |    | SUV (Compact SUV-J Segment)           |             |   |  |
| 1.2 TCe 125 (H5F 404)            | Gasolina | FWD | 1197 | 92 | 125                                   | 10.13-01.18 | * |  |
| 1.2 TCe 125 (H5F 408)            | Gasolina | FWD | 1197 | 92 | 125                                   | 10.13-01.18 | * |  |
| 1.2 TCe 125 4x4 (H5F 410)        | Gasolina | 4WD | 1197 | 92 | 125                                   | 06.15-01.18 | * |  |
| 1.6 16V 4x4 (K4M 606)            | Gasolina | 4WD | 1598 | 77 | 105                                   | 06.10-01.18 | * |  |
| 1.6 SCe 115 (H4M 438)            | Gasolina | FWD | 1598 | 84 | 115                                   | 06.15-01.18 | * |  |
| 1.6 SCe 115 (H4M 738)            | Gasolina | FWD | 1598 | 84 | 115                                   | 06.15-01.18 | * |  |
| 1.6 SCe 115 4x4 (H4M 430)        | Gasolina | 4WD | 1598 | 84 | 115                                   | 06.15-01.18 | * |  |
| 1.6 SCe 115 4x4 (H4M 730)        | Gasolina | 4WD | 1598 | 84 | 115                                   | 06.15-01.18 | * |  |
| 1.6 SCe 115 4x4 (H4M 738)        | Gasolina | 4WD | 1598 | 84 | 115                                   | 06.15-01.18 | * |  |

# LISTA DE APLICACIONES - BUYERS GUIDE

|                                    |  |                  |     |      |     |                                    |             |   |
|------------------------------------|--|------------------|-----|------|-----|------------------------------------|-------------|---|
| 1.6 16V LPG (K4M 616)              |  | Gasol./Gas (LPG) | FWD | 1598 | 77  | 105                                | 04.11-01.18 | * |
| 1.6 16V LPG (K4M 642)              |  | Gasol./Gas (LPG) | FWD | 1598 | 77  | 105                                | 04.11-01.18 | * |
| 1.6 16V Hi-Flex (K4M 696)          |  | Gasol./Etanol    | FWD | 1598 | 77  | 105                                | 08.10-01.18 | * |
| 1.6 SCe 115 LPG (H4M 740)          |  | Gasol./Etanol    | FWD | 1598 | 84  | 115                                | 06.15-01.18 | * |
| 1.5 dCi (K9K 796)                  |  | Diesel           | FWD | 1461 | 63  | 86                                 | 04.10-01.18 | * |
| 1.5 dCi (K9K 830)                  |  | Diesel           | FWD | 1461 | 63  | 86                                 | 04.10-01.18 | * |
| 1.5 dCi (HSAJ) (K9K 612)           |  | Diesel           | FWD | 1461 | 66  | 90                                 | 10.10-01.18 | * |
| 1.5 dCi (HSAJ) (K9K 884)           |  | Diesel           | FWD | 1461 | 66  | 90                                 | 10.10-01.18 | * |
| 1.5 dCi (HSAJ) (K9K 892)           |  | Diesel           | FWD | 1461 | 66  | 90                                 | 10.10-01.18 | * |
| 1.5 dCi 4x4 (K9K 884)              |  | Diesel           | 4WD | 1461 | 66  | 90                                 | 10.10-01.18 | * |
| 1.5 dCi 4x4 (K9K 894)              |  | Diesel           | 4WD | 1461 | 66  | 90                                 | 10.10-01.18 | * |
| 1.5 dCi (HSMC) (K9K 896)           |  | Diesel           | FWD | 1461 | 79  | 107                                | 06.10-01.18 | * |
| 1.5 dCi 4x4                        |  | Diesel           | 4WD | 1461 | 79  | 107                                | 06.10-      | * |
| 1.5 dCi (K9K 658)                  |  | Diesel           | FWD | 1461 | 80  | 109                                | 08.13-01.18 | * |
| 1.5 dCi (K9K 666)                  |  | Diesel           | FWD | 1461 | 80  | 109                                | 08.13-01.18 | * |
| 1.5 dCi (K9K 667)                  |  | Diesel           | FWD | 1461 | 80  | 109                                | 08.13-01.18 | * |
| 1.5 dCi (K9K 856)                  |  | Diesel           | FWD | 1461 | 80  | 109                                | 08.13-01.18 | * |
| 1.5 dCi (K9K 858)                  |  | Diesel           | FWD | 1461 | 80  | 109                                | 08.13-01.18 | * |
| 1.5 dCi 4x4 (K9K 658)              |  | Diesel           | 4WD | 1461 | 80  | 109                                | 08.13-01.18 | * |
| 1.5 dCi 4x4 (K9K 856)              |  | Diesel           | 4WD | 1461 | 80  | 109                                | 08.13-01.18 | * |
| 1.5 dCi 4x4 (K9K 858)              |  | Diesel           | 4WD | 1461 | 80  | 109                                | 08.13-01.18 | * |
| 1.5 dCi 4x4 (K9K 898)              |  | Diesel           | 4WD | 1461 | 80  | 109                                | 08.13-01.18 | * |
| 1.5 dCi (HSMD, HSM3) (K9K 658)     |  | Diesel           | FWD | 1461 | 81  | 110                                | 08.13-01.18 | * |
| 1.5 dCi (HSMD, HSM3) (K9K 856)     |  | Diesel           | FWD | 1461 | 81  | 110                                | 08.13-01.18 | * |
| 1.5 dCi (HSMD, HSM3) (K9K 858)     |  | Diesel           | FWD | 1461 | 81  | 110                                | 08.13-01.18 | * |
| 1.5 dCi (HSMD, HSM3) (K9K 898)     |  | Diesel           | FWD | 1461 | 81  | 110                                | 08.13-01.18 | * |
| 1.5 dCi 4x4 (HSMC, HSMD) (K9K 856) |  | Diesel           | 4WD | 1461 | 81  | 110                                | 10.10-01.18 | * |
| 1.5 dCi 4x4 (HSMC, HSMD) (K9K 858) |  | Diesel           | 4WD | 1461 | 81  | 110                                | 10.10-01.18 | * |
| 1.5 dCi 4x4 (HSMC, HSMD) (K9K 898) |  | Diesel           | 4WD | 1461 | 81  | 110                                | 10.10-01.18 | * |
| <b>DUSTER II (HM_) 10.17-</b>      |  |                  |     |      |     | <b>SUV (Compact SUV-J Segment)</b> |             |   |
| 1.0 TCe 90                         |  | Gasolina         | FWD | 999  | 67  | 91                                 | 05.21-      | * |
| 1.0 TCe 100 (HMMT) (H4D 450)       |  | Gasolina         | FWD | 999  | 74  | 101                                | 01.19-      | * |
| 1.0 TCe 100 (HMMT) (H4D 460)       |  | Gasolina         | FWD | 999  | 74  | 101                                | 01.19-      | * |
| 1.0 TCe 100 4x4 (HMMT) (H4D 450)   |  | Gasolina         | 4WD | 999  | 74  | 101                                | 01.19-      | * |
| 1.0 TCe 100 4x4 (HMMT) (H4D 460)   |  | Gasolina         | 4WD | 999  | 74  | 101                                | 01.19-      | * |
| 1.2 TCe 125 (HMM3) (H5F 408)       |  | Gasolina         | FWD | 1197 | 92  | 125                                | 10.17-      | * |
| 1.2 TCe 125 4x4 (HMM3) (H5F 410)   |  | Gasolina         | 4WD | 1197 | 92  | 125                                | 10.17-      | * |
| 1.3 TCe 130 (HMMF) (H5H 470)       |  | Gasolina         | FWD | 1332 | 96  | 131                                | 01.19-      | * |
| 1.3 TCe 130 (HMMF) (H5H 480)       |  | Gasolina         | FWD | 1332 | 96  | 131                                | 01.19-      | * |
| 1.3 TCe 130 4x4 (HMMF) (H5H 470)   |  | Gasolina         | 4WD | 1332 | 96  | 131                                | 01.19-      | * |
| 1.3 TCe 130 4x4 (HMMF) (H5H 480)   |  | Gasolina         | 4WD | 1332 | 96  | 131                                | 01.19-      | * |
| 1.3 TCe 150 (HMM3) (H5H 470)       |  | Gasolina         | FWD | 1332 | 110 | 150                                | 01.19-      | * |
| 1.3 TCe 150 (HMM3) (H5H 480)       |  | Gasolina         | FWD | 1332 | 110 | 150                                | 01.19-      | * |
| 1.3 TCe 150 4x4 (HMM3) (H5H 470)   |  | Gasolina         | 4WD | 1332 | 110 | 150                                | 01.19-      | * |
| 1.3 TCe 150 4x4 (HMM3) (H5H 480)   |  | Gasolina         | 4WD | 1332 | 110 | 150                                | 01.19-      | * |
| 1.6 SCe 115 (HMM1) (H4M 738)       |  | Gasolina         | FWD | 1598 | 84  | 115                                | 10.17-      | * |
| 1.6 SCe 115 4x4 (HMM1)             |  | Gasolina         | 4WD | 1598 | 84  | 115                                | 10.17-      | * |
| 1.0 TCe LPG                        |  | Gasol./Gas (LPG) | FWD | 999  | 67  | 91                                 | 06.21-      | * |

# LISTA DE APLICACIONES - BUYERS GUIDE

|                                      |  |                  |     |      |  |     |             |   |
|--------------------------------------|--|------------------|-----|------|--|-----|-------------|---|
| 1.0 LPG (HMMT)                       |  | Gasol./Gas (LPG) | FWD | 999  | 74                                       | 101 | 01.19-      | * |
| 1.6 SCe 115 LPG (HMM1) (H4M 740)     |  | Gasol./Gas (LPG) | FWD | 1598 | 80                                       | 109 | 10.17-      | * |
| 1.5 dCi 90 (HMAA) (K9K 656)          |  | Diesel           | FWD | 1461 | 66                                       | 90  | 10.17-      | * |
| 1.5 dCi 95 (HMAF)                    |  | Diesel           | FWD | 1461 | 70                                       | 95  | 10.17-      | * |
| 1.5 dCi 110 (HMAB) (K9K 656)         |  | Diesel           | FWD | 1461 | 80                                       | 109 | 10.17-      | * |
| 1.5 dCi 110 (HMAB) (K9K 667)         |  | Diesel           | FWD | 1461 | 80                                       | 109 | 10.17-      | * |
| 1.5 dCi 110 4x4 (HMAB) (K9K 658)     |  | Diesel           | 4WD | 1461 | 80                                       | 109 | 10.17-      | * |
| 1.5 dCi 115 4x4                      |  | Diesel           | 4WD | 1461 | 84                                       | 114 | 01.22-      | * |
| 1.5 dCi 115 (HMAD) (K9K 872)         |  | Diesel           | FWD | 1461 | 85                                       | 116 | 10.17-      | * |
| 1.5 dCi 115 (HMAD) (K9K 874)         |  | Diesel           | FWD | 1461 | 85                                       | 116 | 10.17-      | * |
| 1.5 dCi 115 4x4 (HMAD) (K9K 872)     |  | Diesel           | 4WD | 1461 | 85                                       | 116 | 10.17-      | * |
| 1.5 dCi 115 4x4 (HMAD) (K9K 874)     |  | Diesel           | 4WD | 1461 | 85                                       | 116 | 10.17-      | * |
| NISSAN                               |  |                  |     |      |  |     |             |   |
| JUKE II (F16_) 08.19-                |  |                  |     |      | SUV (Mini SUV-J Segment)                 |     |             |   |
| 1.0                                  |  | Gasolina         | FWD | 999  | 84                                       | 114 | 08.19-      | * |
| DIG-T 117 (HR10DDT)                  |  | Gasolina         | FWD | 999  | 86                                       | 117 | 08.19-      | * |
| TERRANO IV / PATHFINDER (D10) 08.13- |  |                  |     |      | SUV (Compact SUV-J Segment)              |     |             |   |
| 1.6                                  |  | Gasolina         | FWD | 1598 | 75                                       | 102 | 03.14-      | * |
| 1.6 4x4                              |  | Gasolina         | 4WD | 1598 | 75                                       | 102 | 03.14-      | * |
| 1.6                                  |  | Gasolina         | FWD | 1598 | 84                                       | 114 | 12.15-      | * |
| 1.6 4x4                              |  | Gasolina         | 4WD | 1598 | 84                                       | 114 | 12.15-      | * |
| 2.0                                  |  | Gasolina         | FWD | 1998 | 98                                       | 133 | 03.14-      | * |
| 2.0 4x4                              |  | Gasolina         | 4WD | 1998 | 98                                       | 133 | 03.14-      | * |
| 2.0 4x4                              |  | Gasolina         | 4WD | 1998 | 105                                      | 143 | 12.15-      | * |
| RENAULT                              |  |                  |     |      |  |     |             |   |
| ARKANA (LCM_, LDN_) 08.19-           |  |                  |     |      | SUV (Compact SUV-J Segment)              |     |             |   |
| 1.3 TCe 150 (LCM3)                   |  | Gasolina         | FWD | 1332 | 110                                      | 150 | 08.19-      | * |
| 1.3 TCe 150 4x4 (LCM3)               |  | Gasolina         | 4WD | 1332 | 110                                      | 150 | 08.19-      | * |
| 1.6 (LCM1)                           |  | Gasolina         | FWD | 1598 | 84                                       | 114 | 08.19-      | * |
| 1.6 4x4 (LCM1)                       |  | Gasolina         | 4WD | 1598 | 84                                       | 114 | 08.19-      | * |
| CAPTUR II 01.20-                     |  |                  |     |      | [CAMBIADO]:Fastback (Mini SUV-J Segment) |     |             |   |
| TCe 90 (HFM6)                        |  | Gasolina         | FWD | 999  | 67                                       | 91  | 09.20-      | * |
| TCe 100 (HFMT) (H4D 450)             |  | Gasolina         | FWD | 999  | 74                                       | 101 | 01.20-      | * |
| TCe 130 (HFMF) (H5H 470)             |  | Gasolina         | FWD | 1332 | 96                                       | 131 | 01.20-      | * |
| TCe 155 (HFMN) (H5H 470)             |  | Gasolina         | FWD | 1332 | 113                                      | 154 | 01.20-      | * |
| 1.0 TCe LPG (HFM6)                   |  | Gasol./Gas (LPG) | FWD | 999  | 67                                       | 91  | 01.21-      | * |
| LPG (HFMT) (H4D 450)                 |  | Gasol./Gas (LPG) | FWD | 999  | 74                                       | 101 | 01.20-      | * |
| TCe 140 (HFN0)                       |  | Gasol./el éc.    | FWD | 1332 | 103                                      | 140 | 09.20-      | * |
| TCe 160 (HFN1)                       |  | Gasol./el éc.    | FWD | 1332 | 116                                      | 158 | 09.20-      | * |
| Blue dCi 95 (HFAF) (K9K 872)         |  | Diesel           | FWD | 1461 | 70                                       | 95  | 01.20-      | * |
| Blue dCi 115 (HFAD) (K9K 872)        |  | Diesel           | FWD | 1461 | 85                                       | 116 | 01.20-      | * |
| Blue dCi 115 (HFAD) (K9K 873)        |  | Diesel           | FWD | 1461 | 85                                       | 116 | 01.20-      | * |
| DUSTER (H79_U.S.A.) 09.12-           |  |                  |     |      | Closed SUV (Compact SUV-J Segment)       |     |             |   |
| 2.0                                  |  | Gasolina         | FWD | 1998 | 99                                       | 135 | 09.12-      | * |
| DUSTER (HS_) 01.11-                  |  |                  |     |      | SUV (Compact SUV-J Segment)              |     |             |   |
| 1.6 16V (HSAT) (K4M 616)             |  | Gasolina         | FWD | 1598 | 75                                       | 102 | 06.11-05.15 | * |

# LISTA DE APLICACIONES - BUYERS GUIDE

|  |  |          |     |      |  |     |             |   |
|--|--|----------|-----|------|--|-----|-------------|---|
| 1.6 16V 4x4 (K4M 490)                        |  | Gasolina | 4WD | 1598 | 75                                     | 102 | 06.11-05.15 | * |
| 1.6 16V 4x4 (K4M 606)                        |  | Gasolina | 4WD | 1598 | 75                                     | 102 | 06.11-05.15 | * |
| 1.6 16V 4x4 (K4M 646)                        |  | Gasolina | 4WD | 1598 | 75                                     | 102 | 06.11-05.15 | * |
| 1.6 16V 4x4 (K4M 690)                        |  | Gasolina | 4WD | 1598 | 75                                     | 102 | 06.11-05.15 | * |
| 1.6 16V                                      |  | Gasolina | FWD | 1598 | 76                                     | 104 | 02.12-      | * |
| 1.6 16V (H4M 438)                            |  | Gasolina | FWD | 1598 | 84                                     | 114 | 06.15-      | * |
| 1.6 16V 4x4 (H4M 430)                        |  | Gasolina | 4WD | 1598 | 84                                     | 114 | 06.15-      | * |
| 2.0 (F4R 403)                                |  | Gasolina | FWD | 1998 | 98                                     | 133 | 02.12-      | * |
| 2.0 (F4R 405)                                |  | Gasolina | FWD | 1998 | 98                                     | 133 | 02.12-      | * |
| 2.0 4x4 (F4R)                                |  | Gasolina | 4WD | 1998 | 99                                     | 135 | 02.12-      | * |
| 2.0  |  | Gasolina | FWD | 1998 | 101                                    | 137 | 01.11-      | * |
| 2.0 4x4 (HSAB, HSA3, HSAJ, HSMS)             |  | Gasolina | 4WD | 1998 | 101                                    | 137 | 01.11-      | * |
| 2.0  |  | Gasolina | FWD | 1998 | 102                                    | 138 | 10.11-      | * |
| 2.0 Flex                                     |  | Gasolina | FWD | 1998 | 104                                    | 141 | 01.11-      | * |
| 2.0 Hi-Flex                                  |  | Gasolina | FWD | 1998 | 104                                    | 141 | 01.11-      | * |
| 2.0 (F4R 402)                                |  | Gasolina | FWD | 1998 | 105                                    | 142 | 10.11-      | * |
| 2.0 (F4R 403)                                |  | Gasolina | FWD | 1998 | 105                                    | 142 | 10.11-      | * |
| 2.0 4x4 (F4R 402)                            |  | Gasolina | 4WD | 1998 | 105                                    | 142 | 10.11-      | * |
| 2.0 4x4 (F4R 403)                            |  | Gasolina | 4WD | 1998 | 105                                    | 142 | 10.11-      | * |
| 2.0 Flex                                     |  | Gasolina | FWD | 1998 | 105                                    | 142 | 10.11-      | * |
| 2.0 Flex                                     |  | Gasolina | FWD | 1998 | 109                                    | 148 | 01.16-      | * |
| 2.0 Flex                                     |  | Gasolina | FWD | 1998 | 109                                    | 148 | 01.16-      | * |
| 1.5 dCi                                      |  | Diesel   | FWD | 1461 | 63                                     | 85  | 06.11-01.18 | * |
| 1.5 dCi                                      |  | Diesel   | FWD | 1461 | 66                                     | 90  | 06.11-      | * |
| 1.5 dCi 4x4 (K9K 884)                        |  | Diesel   | 4WD | 1461 | 66                                     | 90  | 06.11-      | * |
| 1.5 dCi 4x4 (HSMD) (K9K 856)                 |  | Diesel   | 4WD | 1461 | 80                                     | 109 | 09.13-01.18 | * |
| 1.5 dCi 4x4 (HSMD) (K9K 858)                 |  | Diesel   | 4WD | 1461 | 80                                     | 109 | 09.13-01.18 | * |
| 1.5 dCi                                      |  | Diesel   | RWD | 1461 | 81                                     | 110 | 02.12-      | * |
| <b>DUSTER II (HM_) 10.17-</b>                |  |          |     |      | <b>SUV (Compact SUV-J Segment)</b>     |     |             |   |
| 1.3 TCe 150 4x4 (HMM3, HMMC)                 |  | Gasolina | 4WD | 1332 | 110                                    | 150 | 11.21-      | * |
| 1.3 TCe 150                                  |  | Gasolina | FWD | 1332 | 113                                    | 154 | 11.21-      | * |
| 1.3 TCe                                      |  | Gasolina | FWD | 1332 | 115                                    | 156 | 11.21-      | * |
| 1.3 TCe 4x4                                  |  | Gasolina | 4WD | 1332 | 115                                    | 156 | 11.21-      | * |
| 1.6 SCe 115 4x4 (HMM1)                       |  | Gasolina | 4WD | 1598 | 84                                     | 114 | 07.19-      | * |
| 2.0 4x4 (HMMS)                               |  | Gasolina | 4WD | 1998 | 105                                    | 143 | 11.21-      | * |
| 1.5 dCi 110 (HMAB) (K9K 656)                 |  | Diesel   | FWD | 1461 | 80                                     | 109 | 07.19-      | * |
| 1.5 dCi 110 (HMAB) (K9K 657)                 |  | Diesel   | FWD | 1461 | 80                                     | 109 | 07.19-      | * |
| 1.5 dCi 110 4x4 (HMAB) (K9K 658)             |  | Diesel   | 4WD | 1461 | 80                                     | 109 | 07.19-      | * |
| <b>EXPRESS 05.21-</b>                        |  |          |     |      | <b>Furgoneta/MPV (LCVs-N1 Segment)</b> |     |             |   |
| 1.3 TCe 100 (F6MA)                           |  | Gasolina | FWD | 1332 | 75                                     | 102 | 05.21-      | * |
| 1.6 SCe 110                                  |  | Gasolina | FWD | 1598 | 82                                     | 110 | 05.21-      | * |
| 1.5 Blue dCi 75 (F6AA)                       |  | Diesel   | FWD | 1461 | 55                                     | 75  | 05.21-      | * |
| 1.5 Blue dCi 95 (F6AB)                       |  | Diesel   | FWD | 1461 | 70                                     | 95  | 05.21-      | * |
| 1.5 dCi 95                                   |  | Diesel   | FWD | 1461 | 70                                     | 95  | 05.21-      | * |
| <b>FLUENCE / SYMBOL (L3_) 02.10-</b>         |  |          |     |      | <b>Sedán (Luxury car-F Segment)</b>    |     |             |   |
| 1.6 16V (K4M 838)                            |  | Gasolina | FWD | 1598 | 78                                     | 106 | 02.10-      | * |
| 1.6 16V (L301, L30F, L30P, L30R) (K4M 838)   |  | Gasolina | FWD | 1598 | 81                                     | 110 | 02.10-      | * |
| 1.6 16V (L301, L30F, L30P, L30R) (K4M 839)   |  | Gasolina | FWD | 1598 | 81                                     | 110 | 02.10-      | * |
| 1.6 16V (L301, L30P, L30R) (K4M 838)         |  | Gasolina | FWD | 1598 | 82                                     | 111 | 02.10-      | * |
| 1.6 (L33T, L33J, L304, L305, L30H) (H4M 729) |  | Gasolina | FWD | 1598 | 86                                     | 117 | 01.13-      | * |

# LISTA DE APLICACIONES - BUYERS GUIDE

|  |  |                  |     |      |   |     |             |   |
|--|--|------------------|-----|------|---|-----|-------------|---|
| 2.0 16V  |  | Gasolina         | FWD | 1997 | 101   | 137 | 05.11-      | * |
| 2.0 16V (L30C, L30G, L30T, L30V) (M4R 714)                         |  | Gasolina         | FWD | 1997 | 103   | 140 | 02.10-      | * |
| 2.0 16V (L30C, L30G, L30T, L30V) (M4R 751)                         |  | Gasolina         | FWD | 1997 | 103   | 140 | 02.10-      | * |
| 2.0 (M4R 714)  |  | Gasolina         | FWD | 1997 | 105   | 143 | 05.14-      | * |
| 2.0 (M4R 751)  |  | Gasolina         | FWD | 1997 | 105   | 143 | 05.14-      | * |
| 1.6 LPG 16V (K4M 839)  |  | Gasol./Gas (LPG) | FWD | 1598 | 81  | 110 | 01.12-      | * |
| 1.6 Flex (L300)  |  | Gasol./Etanol    | FWD | 1598 | 85  | 115 | 01.12-11.14 | * |
| Z.E. (5AM 400)   |  | Eléctrico        | FWD |      | 70  | 95  | 02.12-      | * |
| 1.5 dCi (L30A) (K9K 830)   |  | Diesel           | FWD | 1461 | 63  | 86  | 02.10-      | * |
| 1.5 dCi (L30S) (K9K 834)   |  | Diesel           | FWD | 1461 | 66  | 90  | 02.10-      | * |
| 1.5 dCi (K9K 826)  |  | Diesel           | FWD | 1461 | 70  | 95  | 07.14-      | * |
| 1.5 dCi (L30B) (K9K 832)   |  | Diesel           | FWD | 1461 | 78  | 106 | 02.10-      | * |
| 1.5 dCi (L30D, L30L, L306, L33F, L33L, L33M, L33V, L33W) (K9K 656) |  | Diesel           | FWD | 1461 | 81  | 110 | 02.10-      | * |
| 1.5 dCi (L30D, L30L, L306, L33F, L33L, L33M, L33V, L33W) (K9K 657) |  | Diesel           | FWD | 1461 | 81  | 110 | 02.10-      | * |
| 1.5 dCi (L30D, L30L, L306, L33F, L33L, L33M, L33V, L33W) (K9K 836) |  | Diesel           | FWD | 1461 | 81  | 110 | 02.10-      | * |
| 1.5 dCi (L30D, L30L, L306, L33F, L33L, L33M, L33V, L33W) (K9K 837) |  | Diesel           | FWD | 1461 | 81  | 110 | 02.10-      | * |
| <b>GRAND SCÉNIC III (JZ0/1_) 02.09-</b>                            |  |                  |     |      | <b>MPV (Compact MPV-M1 Segment)</b>                     |     |             |   |
| 1.6 16V (JZ0U) (K4M 858)   |  | Gasolina         | FWD | 1598 | 81  | 109 | 02.09-09.16 | * |
| 1.5 dCi (JZ0A) (K9K 830)   |  | Diesel           | FWD | 1461 | 63  | 86  | 04.09-09.16 | * |
| <b>KANGOO III 06.21-</b>   |  |                  |     |      | <b>Furgoneta/MPV (LCVs-N1 Segment)</b>                  |     |             |   |
| 1.3 TCe 100 (FJMA)   |  | Gasolina         | FWD | 1332 | 75  | 102 | 06.21-      | * |
| 1.3 TCe 130 (FJMB)   |  | Gasolina         | FWD | 1332 | 96  | 131 | 06.21-      | * |
| E-Tech Electric (FJJA)   |  | Eléctrico        | FWD |      | 90  | 122 | 04.22-      | * |
| 1.5 Blue dCi 75 (FJAA)   |  | Diesel           | FWD | 1461 | 55  | 75  | 06.21-      | * |
| 1.5 Blue dCi 95 (FJAB)   |  | Diesel           | FWD | 1461 | 70  | 95  | 06.21-      | * |
| 1.5 Blue dCi 115 (FJAC)  |  | Diesel           | FWD | 1461 | 85  | 116 | 06.21-      | * |
| <b>KANGOO III 07.21-</b>   |  |                  |     |      | <b>MPV (LCVs-N1 Segment)</b>                            |     |             |   |
| TCe 100 (KJMA)   |  | Gasolina         | FWD | 1332 | 75  | 102 | 07.21-      | * |
| TCe 130 (KJMB)   |  | Gasolina         | FWD | 1332 | 96  | 131 | 07.21-      | * |
| E-Tech Electric (KJJA)   |  | Eléctrico        | FWD |      | 90  | 122 | 04.22-      | * |
| Blue dCi 75 (KJAA)   |  | Diesel           | FWD | 1461 | 55  | 75  | 07.21-      | * |
| Blue dCi 95 (KJAB)   |  | Diesel           | FWD | 1461 | 70  | 95  | 07.21-      | * |
| Blue dCi 115 (KJAC)  |  | Diesel           | FWD | 1461 | 85  | 116 | 10.21-      | * |
| <b>KAPTUR (H5_) 03.16-</b>   |  |                  |     |      | <b>[CAMBIADO]:Fastback (Mini SUV-J Segment)</b>         |     |             |   |
| 1.3 TCe 150 (H5M3)   |  | Gasolina         | FWD | 1332 | 110   | 150 | 10.21-      | * |
| 1.3 TCe 150 4x4 (H5M3)   |  | Gasolina         | 4WD | 1332 | 110   | 150 | 10.21-      | * |
| 2.0 4WD (F4R 410)  |  | Gasolina         | 4WD | 1998 | 105   | 143 | 03.16-      | * |
| <b>LAGUNA III (BT0/1) 10.07-</b>                                   |  |                  |     |      | <b>[CAMBIADO]:Fastback (Large family car-D Segment)</b> |     |             |   |
| 1.6 16V (BT04, BT0D, BT0U) (K4M 824)                               |  | Gasolina         | FWD | 1598 | 81  | 110 | 10.07-12.15 | * |
| 1.5 dCi (BT00, BT0A, BT0T, BT1J) (K9K 780)                         |  | Diesel           | FWD | 1461 | 81  | 110 | 10.07-12.15 | * |
| 1.5 dCi (BT00, BT0A, BT0T, BT1J) (K9K 782)                         |  | Diesel           | FWD | 1461 | 81  | 110 | 10.07-12.15 | * |
| <b>LAGUNA III (DT0/1) 09.08-</b>                                   |  |                  |     |      | <b>Coupé (Large family car-D Segment)</b>               |     |             |   |
| 1.5 dCi (K9K 846)  |  | Diesel           | FWD | 1461 | 81  | 110 | 03.12-12.15 | * |
| <b>LAGUNA III Grandtour (KT0/1) 10.07-</b>                         |  |                  |     |      | <b>[CAMBIADO]:Break (Large family car-D Segment)</b>    |     |             |   |
| 1.6 16V (KT0D) (K4M 824)   |  | Gasolina         | FWD | 1598 | 81  | 110 | 10.07-12.15 | * |

# LISTA DE APLICACIONES - BUYERS GUIDE

|  |  |                  |     |      |  |     |             |   |
|--|--|------------------|-----|------|--|-----|-------------|---|
| 1.5 dCi (KT0A, KT0R, KT02) (K9K 780)             |  | Diesel           | FWD | 1461 | 81   | 110 | 10.07-12.15 | * |
| 1.5 dCi (KT0A, KT0R, KT02) (K9K 782)             |  | Diesel           | FWD | 1461 | 81   | 110 | 10.07-12.15 | * |
| 1.5 dCi (KT0A, KT0R, KT02) (K9K 846)             |  | Diesel           | FWD | 1461 | 81   | 110 | 10.07-12.15 | * |
| 2.0 dCi (KT07, KT0J, KT14, KT1A, KT1S) (M9R 742) |  | Diesel           | FWD | 1995 | 96   | 131 | 10.07-12.15 | * |
| 2.0 dCi (KT07, KT0J, KT14, KT1A, KT1S) (M9R 744) |  | Diesel           | FWD | 1995 | 96   | 131 | 10.07-12.15 | * |
| 2.0 dCi (KT07, KT0J, KT14, KT1A, KT1S) (M9R 802) |  | Diesel           | FWD | 1995 | 96   | 131 | 10.07-12.15 | * |
| 2.0 dCi (KT07, KT0J, KT14, KT1A, KT1S) (M9R 814) |  | Diesel           | FWD | 1995 | 96   | 131 | 10.07-12.15 | * |
| 2.0 dCi (KT07, KT0J, KT14, KT1A, KT1S) (M9R 854) |  | Diesel           | FWD | 1995 | 96   | 131 | 10.07-12.15 | * |
| 2.0 dCi (KT07, KT0J, KT14, KT1A, KT1S) (M9R 858) |  | Diesel           | FWD | 1995 | 96   | 131 | 10.07-12.15 | * |
| <b>MEGANE IV 10.16-</b>                          |  |                  |     |      | <b>Sedán (Compact car-C Segment)</b>               |     |             |   |
| 1.2 TCe 130 (H5F 408)                            |  | Gasolina         | FWD | 1197 | 97   | 130 | 10.16-      | * |
| 1.5 Blue dCi 95 (LVA2) (K9K 872)                 |  | Diesel           | FWD | 1461 | 70   | 95  | 02.19-      | * |
| 1.5 dCi 110                                      |  | Diesel           | FWD | 1461 | 81   | 110 | 10.16-      | * |
| 1.5 Blue dCi 115 (LVA6) (K9K 872)                |  | Diesel           | FWD | 1461 | 85   | 115 | 02.19-      | * |
| 1.5 Blue dCi 115 (LVA6) (K9K 873)                |  | Diesel           | FWD | 1461 | 85   | 115 | 02.19-      | * |
| <b>MEGANE III (BZ0/1_, B3_) 11.08-</b>           |  |                  |     |      | <b>[CAMBIADO]:Fastback (Compact car-C Segment)</b> |     |             |   |
| 1.2 TCe (BZ16, BZ28) (H5F 404)                   |  | Gasolina         | FWD | 1197 | 97   | 132 | 01.13-01.16 | * |
| 1.2 TCe (BZ16, BZ28) (H5F 405)                   |  | Gasolina         | FWD | 1197 | 97   | 132 | 01.13-01.16 | * |
| 1.2 TCe (BZ16, BZ28) (H5F 412)                   |  | Gasolina         | FWD | 1197 | 97   | 132 | 01.13-01.16 | * |
| 1.2 TCe (BZ2B, BZ11) (H5F 400)                   |  | Gasolina         | FWD | 1198 | 85   | 116 | 03.12-08.15 | * |
| 1.2 TCe (BZ2B, BZ11) (H5F 408)                   |  | Gasolina         | FWD | 1198 | 85   | 116 | 03.12-08.15 | * |
| 1.4 TCe (BZ0F, BZ1V) (H4J 700)                   |  | Gasolina         | FWD | 1397 | 96   | 131 | 04.09-08.15 | * |
| 1.6 16V (BZ0H) (K4M 848)                         |  | Gasolina         | FWD | 1598 | 74   | 101 | 11.08-08.15 | * |
| 1.6 16V (BZ0H, BZ1R) (K4M 848)                   |  | Gasolina         | FWD | 1598 | 78   | 106 | 01.10-08.15 | * |
| 1.6 16V (BZ1B, BZ1H) (K4M 858)                   |  | Gasolina         | FWD | 1598 | 81   | 110 | 11.08-03.17 | * |
| 1.6 16V (K4M 858)                                |  | Gasolina         | FWD | 1598 | 82   | 111 | 11.08-01.16 | * |
| 1.6 16V (K4M 866)                                |  | Gasolina         | FWD | 1598 | 82   | 111 | 11.08-01.16 | * |
| 1.6 16V (K4M 848)                                |  | Gasolina         | FWD | 1598 | 85   | 116 | 01.13-08.15 | * |
| 1.6 16V (K4M 858)                                |  | Gasolina         | FWD | 1598 | 85   | 116 | 01.13-08.15 | * |
| 1.6 (B332) (H4M 729)                             |  | Gasolina         | FWD | 1598 | 86   | 117 | 01.14-01.16 | * |
| 2.0 CVT (BZ0G, BZ1P) (M4R 711)                   |  | Gasolina         | FWD | 1997 | 103  | 140 | 02.09-08.15 | * |
| 2.0 CVT (BZ0G, BZ1P) (M4R 713)                   |  | Gasolina         | FWD | 1997 | 103  | 140 | 02.09-08.15 | * |
| 2.0 (M4R 710)                                    |  | Gasolina         | FWD | 1997 | 105  | 143 | 01.11-08.15 | * |
| 2.0 (M4R 714)                                    |  | Gasolina         | FWD | 1997 | 105  | 143 | 01.11-08.15 | * |
| 1.6 16V BiFuel (BZ1U, BZ0U) (K4M 858)            |  | Gasol./Gas (LPG) | FWD | 1598 | 81   | 110 | 05.09-08.15 | * |
| 1.6 16V Hi-Flex (BZ03) (K4M 858)                 |  | Gasol./Etanol    | FWD | 1598 | 81   | 110 | 11.08-08.15 | * |
| 1.6 16V Hi-Flex (BZ03) (K4M 866)                 |  | Gasol./Etanol    | FWD | 1598 | 81   | 110 | 11.08-08.15 | * |
| 1.5 dCi (K9K 830)                                |  | Diesel           | FWD | 1461 | 63   | 86  | 11.08-08.15 | * |
| 1.5 dCi (BZ0C) (K9K 834)                         |  | Diesel           | FWD | 1461 | 66   | 90  | 11.08-08.15 | * |
| 1.5 dCi (BZ1G, BZ1W, BZ0R) (K9K 846)             |  | Diesel           | FWD | 1461 | 70   | 95  | 11.13-08.15 | * |
| 1.5 dCi (K9K 832)                                |  | Diesel           | FWD | 1461 | 78   | 106 | 02.09-01.16 | * |
| 1.5 dCi (BZ09, BZ0D, BZ1W, BZ29, BZ14) (K9K 636) |  | Diesel           | FWD | 1461 | 81   | 110 | 02.09-12.15 | * |
| 1.5 dCi (BZ09, BZ0D, BZ1W, BZ29, BZ14) (K9K 836) |  | Diesel           | FWD | 1461 | 81   | 110 | 02.09-12.15 | * |
| 1.5 dCi (BZ09, BZ0D, BZ1W, BZ29, BZ14) (K9K 837) |  | Diesel           | FWD | 1461 | 81   | 110 | 02.09-12.15 | * |
| 1.5 dCi (BZ09, BZ0D, BZ1W, BZ29, BZ14) (K9K 846) |  | Diesel           | FWD | 1461 | 81   | 110 | 02.09-12.15 | * |

# LISTA DE APLICACIONES - BUYERS GUIDE

|  |  |                  |     |      |   |     |             |   |
|--|--|------------------|-----|------|---|-----|-------------|---|
| 1.6 dCi (BZ00, BZ12, BZ13) (R9M 402)                                   |  | Diesel           | FWD | 1598 | 96  | 130 | 04.11-08.15 | * |
| 1.6 dCi (BZ00, BZ12, BZ13) (R9M 404)                                   |  | Diesel           | FWD | 1598 | 96  | 130 | 04.11-08.15 | * |
| 1.9 dCi (BZ0N, BZ0J) (F9Q 870)   |  | Diesel           | FWD | 1870 | 96  | 131 | 11.08-01.16 | * |
| 1.9 dCi (BZ0N, BZ0J) (F9Q 872)   |  | Diesel           | FWD | 1870 | 96  | 131 | 11.08-01.16 | * |
| <b>MEGANE III (DZ0/1_) 11.08-</b>                                      |  |                  |     |      | <b>Coupé (Compact car-C Segment)</b>            |     |             |   |
| 1.2 TCe (DZ16, DZ28) (H5F 404)   |  | Gasolina         | FWD | 1197 | 97  | 132 | 01.13-08.15 | * |
| 1.2 TCe (DZ16, DZ28) (H5F 405)   |  | Gasolina         | FWD | 1197 | 97  | 132 | 01.13-08.15 | * |
| 1.2 TCe (DZ16, DZ28) (H5F 412)   |  | Gasolina         | FWD | 1197 | 97  | 132 | 01.13-08.15 | * |
| 1.2 TCe (DZ2B, DZ11) (H5F 400)   |  | Gasolina         | FWD | 1198 | 85  | 116 | 03.12-08.15 | * |
| 1.2 TCe (DZ2B, DZ11) (H5F 408)   |  | Gasolina         | FWD | 1198 | 85  | 116 | 03.12-08.15 | * |
| 1.4 TCe (DZ0F, DZ1V) (H4J 700)   |  | Gasolina         | FWD | 1397 | 96  | 131 | 04.09-08.15 | * |
| 1.6 16V (DZ0H) (K4M 848)   |  | Gasolina         | FWD | 1598 | 74  | 101 | 11.08-08.15 | * |
| 1.6 16V (DZ0U, DZ1B, DZ1H) (K4M 858)                                   |  | Gasolina         | FWD | 1598 | 81  | 110 | 11.08-08.15 | * |
| 2.0 CVT (DZ0G, DZ1E) (M4R 711)   |  | Gasolina         | FWD | 1997 | 103   | 140 | 05.09-08.15 | * |
| 1.6 16V Bifuel (DZ03, DZ1Y) (K4M 866)                                  |  | Gasol./Gas (LPG) | FWD | 1598 | 81  | 110 | 11.08-08.15 | * |
| 1.5 dCi (DZ0A) (K9K 830)   |  | Diesel           | FWD | 1461 | 63  | 86  | 11.08-08.15 | * |
| 1.5 dCi (DZ0C, DZ1A) (K9K 834)   |  | Diesel           | FWD | 1461 | 66  | 90  | 11.08-08.15 | * |
| 1.5 dCi (K9K 846)  |  | Diesel           | FWD | 1461 | 70  | 95  | 07.14-08.15 | * |
| 1.5 dCi (DZ0B) (K9K 832)   |  | Diesel           | FWD | 1461 | 78  | 106 | 02.09-08.15 | * |
| 1.5 dCi (DZ09, DZ0D, DZ1F, DZ1G, DZ14, DZ29) (K9K 636)                 |  | Diesel           | FWD | 1461 | 81  | 110 | 02.09-08.15 | * |
| 1.5 dCi (DZ09, DZ0D, DZ1F, DZ1G, DZ14, DZ29) (K9K 836)                 |  | Diesel           | FWD | 1461 | 81  | 110 | 02.09-08.15 | * |
| 1.5 dCi (DZ09, DZ0D, DZ1F, DZ1G, DZ14, DZ29) (K9K 837)                 |  | Diesel           | FWD | 1461 | 81  | 110 | 02.09-08.15 | * |
| 1.5 dCi (DZ09, DZ0D, DZ1F, DZ1G, DZ14, DZ29) (K9K 846)                 |  | Diesel           | FWD | 1461 | 81  | 110 | 02.09-08.15 | * |
| 1.6 dCi (DZ00, DZ12, DZ2A, DZ13) (R9M 402)                             |  | Diesel           | FWD | 1598 | 96  | 130 | 04.11-08.15 | * |
| 1.9 dCi (DZ0N, DZ0J, DZ1J, DZ1K) (F9Q 870)                             |  | Diesel           | FWD | 1870 | 96  | 131 | 11.08-08.15 | * |
| 1.9 dCi (DZ0N, DZ0J, DZ1J, DZ1K) (F9Q 872)                             |  | Diesel           | FWD | 1870 | 96  | 131 | 11.08-08.15 | * |
| <b>MEGANE III (B95) 06.09-</b>   |  |                  |     |      | <b>Sedán (Compact car-C Segment)</b>            |     |             |   |
| 1.6 16V  |  | Gasolina         | FWD | 1598 | 82  | 112 | 06.09-      | * |
| <b>MEGANE III Grandtour (KZ0/1) 11.08-</b>                             |  |                  |     |      | <b>[CAMBIADO]:Break (Compact car-C Segment)</b> |     |             |   |
| 1.2 TCe (KZ2B, KZ11) (H5F 400)   |  | Gasolina         | FWD | 1198 | 85  | 116 | 03.12-08.15 | * |
| 1.2 TCe (KZ2B, KZ11) (H5F 408)   |  | Gasolina         | FWD | 1198 | 85  | 116 | 03.12-08.15 | * |
| 1.4 TCe (KZ0F, KZ1V) (H4J 700)   |  | Gasolina         | FWD | 1397 | 96  | 130 | 05.09-08.15 | * |
| 1.6 16V (KZ0H) (K4M 848)   |  | Gasolina         | FWD | 1598 | 74  | 101 | 05.09-08.15 | * |
| 1.6 16V (KZ0U, KZ1B, KZ1U) (K4M 858)                                   |  | Gasolina         | FWD | 1598 | 81  | 110 | 05.09-08.15 | * |
| 1.6 16V (KZ0U, KZ1B, KZ1U) (K4M 866)                                   |  | Gasolina         | FWD | 1598 | 81  | 110 | 05.09-08.15 | * |
| 2.0 CVT (KZ0G, KZ1P) (M4R 711)   |  | Gasolina         | FWD | 1997 | 103   | 140 | 05.09-08.15 | * |
| 2.0 CVT (KZ0G, KZ1P) (M4R 713)   |  | Gasolina         | FWD | 1997 | 103   | 140 | 05.09-08.15 | * |
| 1.6 BiFuel (KZ03) (K4M 866)  |  | Gasol./Gas (LPG) | FWD | 1598 | 81  | 110 | 11.08-08.15 | * |
| 1.5 dCi (K9K 830)  |  | Diesel           | FWD | 1461 | 63  | 86  | 03.09-08.15 | * |
| 1.5 dCi (KZ0C, KZ1A) (K9K 834)   |  | Diesel           | FWD | 1461 | 66  | 90  | 05.09-08.15 | * |
| 1.5 dCi (KZ1M, KZ1W, KZ0R) (K9K 832)                                   |  | Diesel           | FWD | 1461 | 78  | 106 | 02.09-08.15 | * |
| 1.5 dCi (KZ1M, KZ1W, KZ0R) (K9K 836)                                   |  | Diesel           | FWD | 1461 | 78  | 106 | 02.09-08.15 | * |
| 1.5 dCi (KZ1M, KZ1W, KZ0R) (K9K 846)                                   |  | Diesel           | FWD | 1461 | 78  | 106 | 02.09-08.15 | * |
| 1.5 dCi (KZ09, KZ0D, KZ1G, KZ29, KZ14, KZ1W, KZ10, KZ1F,...) (K9K 636) |  | Diesel           | FWD | 1461 | 81  | 110 | 02.09-08.15 | * |
| 1.5 dCi (KZ09, KZ0D, KZ1G, KZ29, KZ14, KZ1W, KZ10, KZ1F,...) (K9K 836) |  | Diesel           | FWD | 1461 | 81  | 110 | 02.09-08.15 | * |
| 1.5 dCi (KZ09, KZ0D, KZ1G, KZ29, KZ14, KZ1W, KZ10, KZ1F,...) (K9K 837) |  | Diesel           | FWD | 1461 | 81  | 110 | 02.09-08.15 | * |

# LISTA DE APLICACIONES - BUYERS GUIDE

|   |          |     |      |  |     |             |   |
|---|----------|-----|------|--|-----|-------------|---|
| 1.5 dCi (KZ09, KZ0D, KZ1G, KZ29, KZ14, KZ1W, KZ10, KZ1F,... (K9K 846) | Diesel   | FWD | 1461 | 81   | 110 | 02.09-08.15 | * |
| 1.6 dCi (KZ00, KZ12, KZ13) (R9M 402)                                  | Diesel   | FWD | 1598 | 96   | 130 | 04.11-08.15 | * |
| 1.6 dCi (KZ00, KZ12, KZ13) (R9M 404)                                  | Diesel   | FWD | 1598 | 96   | 130 | 04.11-08.15 | * |
| 1.6 dCi (KZ00, KZ12, KZ13) (R9M 414)                                  | Diesel   | FWD | 1598 | 96   | 130 | 04.11-08.15 | * |
| 1.9 dCi (KZ0J, KZ0N, KZ1S) (F9Q 870)                                  | Diesel   | FWD | 1870 | 96   | 131 | 05.09-08.15 | * |
| 1.9 dCi (KZ0J, KZ0N, KZ1S) (F9Q 872)                                  | Diesel   | FWD | 1870 | 96   | 131 | 05.09-08.15 | * |
| <b>MEGANE III Hatchback Van (BZ_) 11.08-08.15</b>                     |          |     |      | <b>Furgón/hatchback (Compact car-C Segment)</b>    |     |             |   |
| 1.5 dCi (BZ0C, BZ1A) (K9K 834)  | Diesel   | FWD | 1461 | 66   | 90  | 11.08-08.15 | * |
| 1.5 dCi (BZ0D, BZ1G, BZ1F, BZ1M, BZ1W, BZ0R, BZ10) (K9K 836)          | Diesel   | FWD | 1461 | 81   | 110 | 02.09-08.15 | * |
| 1.5 dCi (BZ0D, BZ1G, BZ1F, BZ1M, BZ1W, BZ0R, BZ10) (K9K 846)          | Diesel   | FWD | 1461 | 81   | 110 | 02.09-08.15 | * |
| <b>MEGANE III CC (EZ0/1_) 06.10-</b>                                  |          |     |      | <b>Cabrio (Compact car-C Segment)</b>              |     |             |   |
| 1.4 TCe (EZ0F, EZ1V) (H4J 700)  | Gasolina | FWD | 1397 | 96   | 131 | 06.10-08.15 | * |
| 1.6 16V (EZ0U, EZ1U) (K4M 858)  | Gasolina | FWD | 1598 | 81   | 110 | 06.10-08.15 | * |
| 2.0 CVT (EZ0G, EZ1E, EZ1P) (M4R 711)                                  | Gasolina | FWD | 1997 | 103  | 140 | 06.10-08.15 | * |
| 2.0 CVT (EZ0G, EZ1E, EZ1P) (M4R 713)                                  | Gasolina | FWD | 1997 | 103  | 140 | 06.10-08.15 | * |
| 1.5 dCi (EZ09, EZ1G, EZ0D, EZ14) (K9K 837)                            | Diesel   | FWD | 1461 | 81   | 110 | 06.10-08.15 | * |
| 1.6 dCi (EZ00) (R9M 402)  | Diesel   | FWD | 1598 | 96   | 130 | 04.11-08.15 | * |
| 1.9 dCi (EZ0J, EZ1S) (F9Q 870)  | Diesel   | FWD | 1870 | 96   | 131 | 06.10-08.15 | * |
| <b>MEGANE IV (B9A/M/N_) 11.15-</b>                                    |          |     |      | <b>[CAMBIADO]:Fastback (Compact car-C Segment)</b> |     |             |   |
| 1.0 TCe 115 (B9MD, B9MW)  | Gasolina | FWD | 999  | 84   | 114 | 10.20-      | * |
| 1.2 TCe 100 (B9MS) (H5F 408)  | Gasolina | FWD | 1197 | 74   | 100 | 11.15-      | * |
| 1.2 TCe 130 (B9MR) (H5F 408)  | Gasolina | FWD | 1197 | 97   | 130 | 11.15-      | * |
| 1.3 TCe 100 (B9N8) (H5H 470)  | Gasolina | FWD | 1332 | 75   | 102 | 08.18-      | * |
| 1.3 TCe 115 (B9N9) (H5H 450)  | Gasolina | FWD | 1332 | 85   | 116 | 01.18-      | * |
| 1.3 TCe 115 (B9N9) (H5H 470)  | Gasolina | FWD | 1332 | 85   | 116 | 01.18-      | * |
| 1.3 TCe 140 (B9NB) (H5H 450)  | Gasolina | FWD | 1332 | 103  | 140 | 01.18-      | * |
| 1.3 TCe 140 (B9NB) (H5H 470)  | Gasolina | FWD | 1332 | 103  | 140 | 01.18-      | * |
| 1.5 Blue dCi 95 (B9A2, B9A6) (K9K 872)                                | Diesel   | FWD | 1461 | 70   | 95  | 08.18-      | * |
| 1.5 dCi 110 (B9A3) (K9K 646)  | Diesel   | FWD | 1461 | 81   | 110 | 11.15-      | * |
| 1.5 dCi 110 (B9A3) (K9K 648)  | Diesel   | FWD | 1461 | 81   | 110 | 11.15-      | * |
| 1.5 dCi 110 (B9A3) (K9K 656)  | Diesel   | FWD | 1461 | 81   | 110 | 11.15-      | * |
| 1.5 dCi 110 (B9A3) (K9K 657)  | Diesel   | FWD | 1461 | 81   | 110 | 11.15-      | * |
| 1.5 Blue dCi 115 (B9A6) (K9K 872)                                     | Diesel   | FWD | 1461 | 85   | 116 | 08.18-      | * |
| 1.5 Blue dCi 115 (B9A6) (K9K 873)                                     | Diesel   | FWD | 1461 | 85   | 116 | 08.18-      | * |
| <b>MEGANE IV Grandtour (K9A/M/N_) 04.16-</b>                          |          |     |      | <b>[CAMBIADO]:Break (Compact car-C Segment)</b>    |     |             |   |
| 1.0 TCe 115 (K9MB, K9MW)  | Gasolina | FWD | 999  | 84   | 114 | 07.21-      | * |
| 1.2 TCe 100 (H5F 408)   | Gasolina | FWD | 1197 | 74   | 100 | 04.16-      | * |
| 1.2 TCe 130 (K9MR) (H5F 408)  | Gasolina | FWD | 1197 | 97   | 130 | 04.16-      | * |
| 1.3 TCe 100 (K9N8) (H5H 470)  | Gasolina | FWD | 1332 | 75   | 102 | 08.18-      | * |
| 1.3 TCe 115 (K9N9) (H5H 450)  | Gasolina | FWD | 1332 | 85   | 116 | 01.18-      | * |
| 1.3 TCe 115 (K9N9) (H5H 470)  | Gasolina | FWD | 1332 | 85   | 116 | 01.18-      | * |
| 1.3 TCe 140 (K9NB) (H5H 450)  | Gasolina | FWD | 1332 | 103  | 140 | 01.18-      | * |
| 1.3 TCe 140 (K9NB) (H5H 470)  | Gasolina | FWD | 1332 | 103  | 140 | 01.18-      | * |
| 1.6 16V (H4M 738)   | Gasolina | FWD | 1598 | 84   | 115 | 04.16-      | * |
| 1.5 dCi 90 (K9K 656)  | Diesel   | FWD | 1461 | 66   | 90  | 04.16-      | * |
| 1.5 Blue dCi 95 (K9A2) (K9K 872)                                      | Diesel   | FWD | 1461 | 70   | 95  | 08.18-      | * |
| 1.5 dCi 110 (K9K 656)   | Diesel   | FWD | 1461 | 81   | 110 | 04.16-      | * |
| 1.5 dCi 110 (K9K 657)   | Diesel   | FWD | 1461 | 81   | 110 | 04.16-      | * |

# LISTA DE APLICACIONES - BUYERS GUIDE

|   |               |     |      |   |     |             |   |
|---|---------------|-----|------|---|-----|-------------|---|
| 1.5 Blue dCi 115 (K9A6) (K9K 872)               | Diesel        | FWD | 1461 | 85  | 116 | 08.18-      | * |
| 1.5 Blue dCi 115 (K9A6) (K9K 873)               | Diesel        | FWD | 1461 | 85  | 116 | 08.18-      | * |
| <b>SCÉNIC III (JZ0/1_) 12.08-</b>               |               |     |      | <b>MPV (Compact MPV-M1 Segment)</b>             |     |             |   |
| 1.6 16V (JZ0U, JZ1B) (K4M 858)                  | Gasolina      | FWD | 1598 | 81  | 110 | 02.09-09.16 | * |
| 1.6 16V (JZ0U, JZ1B) (K4M R 858)                | Gasolina      | FWD | 1598 | 81  | 110 | 02.09-09.16 | * |
| 1.6 E85 (JZ03, JZ1Y) (K4M 866)                  | Gasol./Etanol | FWD | 1598 | 81  | 110 | 02.09-09.16 | * |
| 1.5 dCi (K9K 830)                               | Diesel        | FWD | 1461 | 63  | 86  | 04.09-09.16 | * |
| 1.5 dCi (K9K 636)                               | Diesel        | FWD | 1461 | 81  | 110 | 04.09-09.16 | * |
| 1.5 dCi (K9K 656)                               | Diesel        | FWD | 1461 | 81  | 110 | 04.09-09.16 | * |
| 1.5 dCi (K9K 657)                               | Diesel        | FWD | 1461 | 81  | 110 | 04.09-09.16 | * |
| 1.5 dCi (K9K 836)                               | Diesel        | FWD | 1461 | 81  | 110 | 04.09-09.16 | * |
| 1.5 dCi (K9K 837)                               | Diesel        | FWD | 1461 | 81  | 110 | 04.09-09.16 | * |
| <b>ZOE (BFM_) 06.12-</b>                        |               |     |      | <b>[CAMBIADO]:Fastback (City car-A Segment)</b> |     |             |   |
| ZOE (BFMC, BFMD) (5AQ 605)                      | Eléctrico     | FWD |      | 100   | 136 | 09.19-      | * |
| <b>ZOE (BFM_) 04.19-</b>                        |               |     |      | <b>Furgón/hatchback (City car-A Segment)</b>    |     |             |   |
| Electric (BFMC, BFMD)                           | Eléctrico     | FWD |      | 100   | 136 | 10.19-      | * |
| <b>VW</b>                                       |               |     |      |   |     |             |   |
| <b>JETTA V / BORA / VENTO (1K2) 09.04-12.13</b> |               |     |      | <b>Sedán (Compact car-C Segment)</b>            |     |             |   |
| 1.6 MultiFuel (CCSA)                            | Gasol./Etanol | FWD | 1595 | 75  | 102 | 01.08-10.10 | * |