

LISTA DE APLICACIONES - BUYERS GUIDE

78RBD22040



8 424073 151889

Weight: 9.256

| O.E.M. | MAKE |
|-------------|--------|
| 43512-0D050 | TOYOTA |
| 43512-17130 | TOYOTA |
| 43512-52040 | TOYOTA |
| 43512-52090 | TOYOTA |

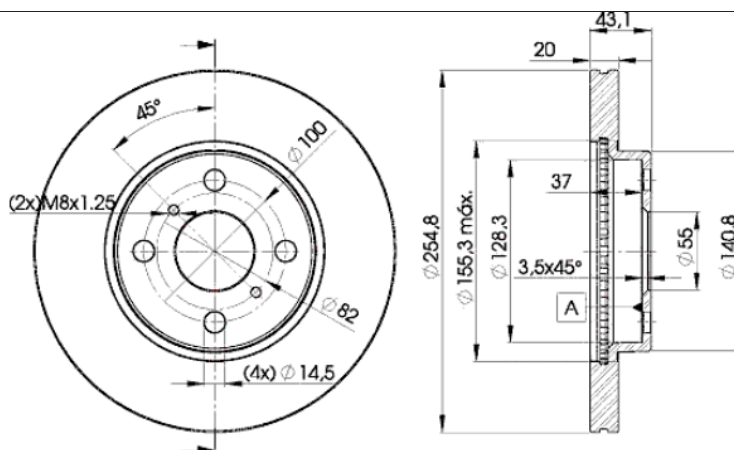

78RBD22040

E1 90R-02C0452/0026



Ø255x20x43.4

Sin Filas



| Trac. | CC | Kw | CV | |
|-------|----|----|----|--------------|
| | | | | Front / Rear |

FAW (TIANJIN)

WEIZHI 01.06-

[CAMBIADO]:Fastback ()

| | | | | | | | |
|-----|----------|-----|------|----|----|-------------|---|
| 1.3 | Gasolina | FWD | 1342 | 64 | 87 | 10.06-12.09 | * |
| 1.3 | Gasolina | FWD | 1342 | 68 | 92 | 01.07-12.10 | * |

WEIZHI V5 04.12-

Sedán ()

| | | | | | | | |
|--------------|----------|-----|------|----|-----|-------------|---|
| 1.5 (CA4GA5) | Gasolina | FWD | 1497 | 75 | 102 | 04.12-04.18 | * |
|--------------|----------|-----|------|----|-----|-------------|---|

GEELY

KINGKONG 06.05-

Sedán ()

| | | | | | | | |
|---------------|----------|-----|------|----|----|-------------|---|
| 1.5 (5A-FE) | Gasolina | FWD | 1498 | 69 | 93 | 05.06-12.10 | * |
| 1.5 (MR479QA) | Gasolina | FWD | 1498 | 69 | 93 | 05.06-12.10 | * |

MK II 01.12-

Sedán (Compact car-C Segment)

| | | | | | | | |
|---------------|----------|-----|------|----|----|--------|---|
| 1.5 (MR479QA) | Gasolina | FWD | 1498 | 69 | 94 | 01.12- | * |
|---------------|----------|-----|------|----|----|--------|---|

GREAT WALL

COOLBEAR / CB150 01.08-12.13

MPV (Large MPV-M1 Segment)

| | | | | | | | |
|--------------|----------|-----|------|----|-----|-------------|---|
| 1.5 (GW4G15) | Gasolina | FWD | 1497 | 77 | 105 | 03.09-12.13 | * |
|--------------|----------|-----|------|----|-----|-------------|---|

FLORID 09.08-

[CAMBIADO]:Fastback ()

| | | | | | | | |
|---------------|----------|-----|------|----|-----|-------------|---|
| 1.3 (GW413EF) | Gasolina | FWD | 1342 | 65 | 88 | 09.08-12.10 | * |
| 1.3 | Gasolina | FWD | 1342 | 68 | 92 | 05.09-12.12 | * |
| 1.5 (GW4G15) | Gasolina | FWD | 1497 | 77 | 105 | 02.09-12.12 | * |

FLORID CROSS 08.09-12.14

[CAMBIADO]:Fastback ()

| | | | | | | | |
|-----|----------|-----|------|----|-----|-------------|---|
| 1.5 | Gasolina | FWD | 1497 | 77 | 105 | 08.09-12.14 | * |
|-----|----------|-----|------|----|-----|-------------|---|

LISTA DE APLICACIONES - BUYERS GUIDE

| HOVER M2 / HAVAL M2 03.10- | | | | | SUV (Compact SUV-J Segment) | | | |
|---|--|----------|-----|------|---|-----|-------------|---|
| 1.5 (GW4G15) | | Gasolina | FWD | 1497 | 73 | 99 | 01.13- | * |
| 1.5 (GW4G15) | | Gasolina | FWD | 1497 | 77 | 105 | 03.10-12.14 | * |
| 1.5 A las 4 ruedas (GW4G15) | | Gasolina | 4WD | 1497 | 77 | 105 | 03.10-12.12 | * |
| HOVER M4 05.12- | | | | | SUV (Compact SUV-J Segment) | | | |
| 1.5 (GW4G15) | | Gasolina | FWD | 1497 | 78 | 106 | 05.12- | * |
| PERI CROSS 03.08-01.10 | | | | | [CAMBIADO]:Fastback () | | | |
| 1.3 (GW413EF) | | Gasolina | FWD | 1342 | 65 | 88 | 03.08-01.10 | * |
| TOYOTA | | | | | | | | |
| bB (NCP3_) 01.00-12.05 | | | | | MPV (Compact MPV-M1 Segment) | | | |
| 1.5 4WD (NCP35) (1NZ-FE) | | Gasolina | 4WD | 1497 | 77 | 105 | 03.00-12.05 | * |
| ECHO (_P1_) 08.99-01.06 | | | | | Sedán (Supermini car-B Segment) | | | |
| 1.5 (NCP12_) (1NZ-FE) | | Gasolina | FWD | 1497 | 81 | 110 | 08.99-12.05 | * |
| IST / XA (NCP6_) 04.02-07.07 | | | | | [CAMBIADO]:Fastback (Supermini car-B Segment) | | | |
| 1.3 VVTi (NCP60) (2NZ-FE) | | Gasolina | FWD | 1299 | 63 | 86 | 05.04-07.07 | * |
| 1.5 VVTi (NCP61_, NCP61) (1NZ-FE) | | Gasolina | FWD | 1497 | 80 | 109 | 05.04-07.07 | * |
| MR 2 III / MR (ZZW3_) 10.99-06.07 | | | | | Cabrío (Sports car-S Segment) | | | |
| 1.8 16V VT-i (ZZW30) (1ZZ-FE) | | Gasolina | RWD | 1794 | 103 | 140 | 10.99-06.07 | * |
| VIOS / SOLUNA VIOS / YARIS / BELTA (_P4_) 07.02-08.13 | | | | | Sedán (Supermini car-B Segment) | | | |
| 1.3 VVTi (AXP41_) (8A-FE) | | Gasolina | FWD | 1342 | 64 | 87 | 07.02-01.08 | * |
| 1.5 VVTi (NCP42_) (1NZ-FE) | | Gasolina | FWD | 1497 | 68 | 92 | 10.02-10.06 | * |
| 1.5 VVTi (NCP42_, NCP42R) (1NZ-FE) | | Gasolina | FWD | 1497 | 80 | 109 | 10.02-10.06 | * |
| 1.5 (AXP42_, NCP42_) (5A-FE) | | Gasolina | FWD | 1498 | 68 | 92 | 07.02-01.08 | * |
| Will CYPHA (NCP7_) 05.01-07.05 | | | | | [CAMBIADO]:Fastback (Compact car-C Segment) | | | |
| 1.3 VVTi (NCP70) (2NZ-FE) | | Gasolina | FWD | 1299 | 62 | 84 | 05.01-07.05 | * |
| 1.5 VVTi 4WD (NCP75) (1NZ-FE) | | Gasolina | 4WD | 1497 | 78 | 106 | 05.01-07.05 | * |
| Will Vi (NCP19_) 01.00-12.01 | | | | | Sedán (Compact car-C Segment) | | | |
| 1.3 (NCP19) (2NZ-FE) | | Gasolina | FWD | 1298 | 64 | 87 | 01.00-12.01 | * |
| YARIS II / VITZ (_P9_) 01.05- | | | | | [CAMBIADO]:Fastback (Supermini car-B Segment) | | | |
| 1.3 VVT-i (SCP90_, SCP90R) (2SZ-FE) | | Gasolina | FWD | 1298 | 64 | 87 | 08.05-11.10 | * |
| YARIS VERSO / ECHO VERSO / FUN CARGO (_P2_) 03.00-09.05 | | | | | Furgón/hatchback (Mini MPV-M1 Segment) | | | |
| 1.3 VVTi (NCP22_) (2NZ-FE) | | Gasolina | FWD | 1299 | 62 | 84 | 04.03-09.05 | * |
| 1.3 VVTi (NCP22_) (2NZ-FE) | | Gasolina | FWD | 1299 | 63 | 86 | 03.00-09.05 | * |
| 1.5 VVTi (NCP21_) (1NZ-FE) | | Gasolina | FWD | 1497 | 78 | 106 | 03.00-03.03 | * |
| 1.4 D4d (NLP22_) (1ND-TV) | | Diesel | FWD | 1364 | 55 | 75 | 10.01-09.05 | * |
| YARIS VERSO / ECHO VERSO / FUN CARGO (_P2_) 08.99-09.05 | | | | | MPV (Mini MPV-M1 Segment) | | | |
| 1.3 (NCP20_, NCP22_, NCP20R, NCP22R) (2NZ-FE) | | Gasolina | FWD | 1299 | 62 | 84 | 11.02-09.05 | * |
| 1.3 (NCP20_, NCP22_, NCP20R, NCP22R) (2NZ-FE) | | Gasolina | FWD | 1299 | 63 | 86 | 08.99-10.02 | * |
| 1.5 (NCP21_) (1NZ-FE) | | Gasolina | FWD | 1497 | 77 | 105 | 03.00-09.05 | * |
| 1.5 (NCP21_) (1NZ-FE) | | Gasolina | FWD | 1497 | 78 | 106 | 03.00-09.05 | * |
| 1.5 4WD (NCP25) (1NZ-FE) | | Gasolina | 4WD | 1497 | 78 | 106 | 03.00-09.05 | * |
| 1.5 (NCP21) | | Gasolina | FWD | 1497 | 80 | 109 | 08.02-09.05 | * |
| 1.5 (NCP21) | | Gasolina | FWD | 1497 | 81 | 110 | 01.00-07.02 | * |
| 1.4 D-4D (NLP20_, NLP22_) (1ND-TV) | | Diesel | FWD | 1364 | 55 | 75 | 09.00-09.05 | * |

LISTA DE APLICACIONES - BUYERS GUIDE

| YARIS / ECHO / VITZ (_P1_) 01.99-12.05 | | | | [CAMBIADO]:Fastback (Supermini car-B Segment) | | | | |
|---|----------|-----|------|---|-----|-------------|---|--|
| 1.0 (SCP10_, SCP10R) (1SZ-FE) | Gasolina | FWD | 998 | 48 | 65 | 03.03-09.05 | * | |
| 1.0 (SCP10_, SCP10R) (1SZ-FE) | Gasolina | FWD | 998 | 50 | 68 | 04.99-09.05 | * | |
| 1.3 (SCP12_, SCP13_, SCP12R, SCP13R) (2SZ-FE) | Gasolina | FWD | 1298 | 64 | 87 | 04.02-09.05 | * | |
| 1.3 | Gasolina | FWD | 1299 | 57 | 76 | 09.03-12.04 | * | |
| 1.3 (NCP10, SCP12_) (2NZ-FE) | Gasolina | FWD | 1299 | 63 | 86 | 08.99-11.05 | * | |
| 1.5 (NCP13_, NCP13R) (1NZ-FE) | Gasolina | FWD | 1497 | 77 | 105 | 01.03-11.05 | * | |
| 1.5 (NCP13_, NCP13R) (1NZ-FE) | Gasolina | FWD | 1497 | 78 | 106 | 04.01-09.05 | * | |
| 1.5 (NCP13_, NCP13R) (1NZ-FE) | Gasolina | FWD | 1497 | 110 | 150 | 03.00-07.05 | * | |
| 1.4 D-4D (NLP10_, NLP10R) (1ND-TV) | Diesel | FWD | 1364 | 55 | 75 | 10.01-09.05 | * | |