

LISTA DE APLICACIONES - BUYERS GUIDE

3R18100920

Weight: 13.080

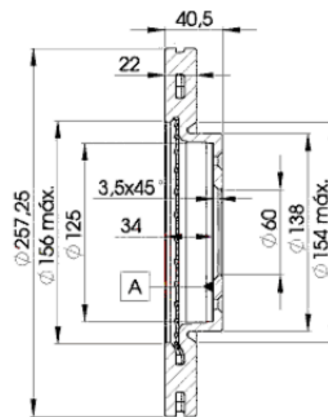
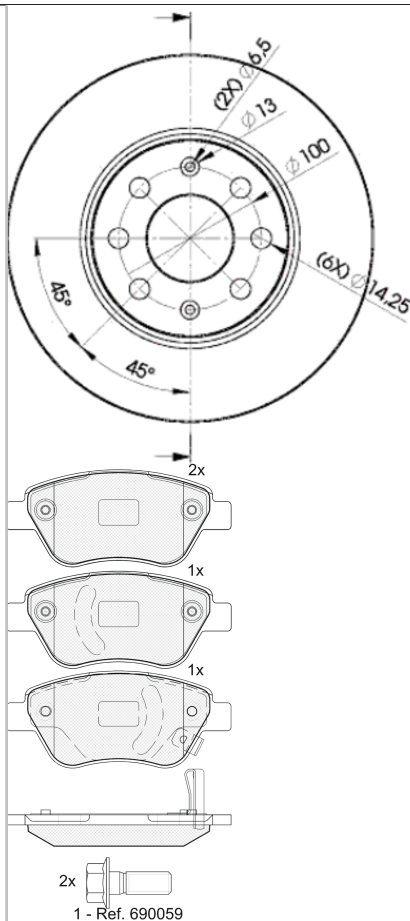

3R18100920



Bosch

122.9x53.2x17.8

Ø257x22x40.5

WVA

23982

24288

Sin Filas



Trac.	CC	Kw	CV		
					Front / Rear

OPEL

CORSA D (S07) 07.06-

[CAMBIADO]:Fastback (Supermini car-B Segment)

1.0 (L08, L68) (Z 10 XEP)	Gasolina	FWD	998	44	60	07.06-12.10	*
1.0 (L08, L68) (Z 10 XEP)	Gasolina	FWD	998	44	60	07.06-12.10	*
1.2 (L08, L68) (Z 12 XEP)	Gasolina	FWD	1229	59	80	07.06-08.14	*
1.2 (L08, L68) (Z 12 XEP)	Gasolina	FWD	1229	59	80	07.06-08.14	*
1.4 (L08, L68) (A 14 XEL)	Gasolina	FWD	1398	64	87	09.09-08.14	*
1.4 (L08, L68) (A 14 XEL)	Gasolina	FWD	1398	64	87	09.09-08.14	*
1.2 LPG (L08, L68) (Z 12 XEP)	Gasol./G as (LPG)	FWD	1229	59	80	08.06-08.14	*
1.2 LPG (L08, L68) (Z 12 XEP)	Gasol./G as (LPG)	FWD	1229	59	80	08.06-08.14	*
1.4 LPG (L08, L68) (Z 14 XEP)	Gasol./G as (LPG)	FWD	1364	66	90	08.06-12.11	*
1.4 LPG (L08, L68) (Z 14 XEP)	Gasol./G as (LPG)	FWD	1364	66	90	08.06-12.11	*
1.3 CDTI (L08, L68) (A 13 DTC)	Diesel	FWD	1248	55	75	07.06-08.14	*
1.3 CDTI (L08, L68) (A 13 DTC)	Diesel	FWD	1248	55	75	07.06-08.14	*
1.3 CDTI (L08, L68) (Z 13 DTJ)	Diesel	FWD	1248	55	75	07.06-08.14	*
1.3 CDTI (L08, L68) (Z 13 DTJ)	Diesel	FWD	1248	55	75	07.06-08.14	*

VAUXHALL

CORSA Mk III (D) (S07) 07.06-08.14

[CAMBIADO]:Fastback (Supermini car-B Segment)

1.0 (L08) (Z 10 XEP)	Gasolina	FWD	998	44	60	08.06-08.14	*
1.0 (L08) (Z 10 XEP)	Gasolina	FWD	998	44	60	08.06-08.14	*
1.2 (L08) (A 12 XEL)	Gasolina	FWD	1229	51	69	06.10-08.14	*
1.2 (L08) (A 12 XEL)	Gasolina	FWD	1229	51	69	06.10-08.14	*

LISTA DE APLICACIONES - BUYERS GUIDE

1.2 (L08) (Z 12 XEP)		Gasolina	FWD	1229	59	80	08.06-08.14	*
1.2 (L08) (Z 12 XEP)		Gasolina	FWD	1229	59	80	08.06-08.14	*
1.4 (L08) (Z 14 XEP)		Gasolina	FWD	1364	66	90	08.06-08.14	*
1.4 (L08) (Z 14 XEP)		Gasolina	FWD	1364	66	90	08.06-08.14	*
1.2 LPG (L08) (Z 12 XEP)		Gasol./Gas (LPG)	FWD	1229	59	80	09.09-08.14	*
1.2 LPG (L08) (Z 12 XEP)		Gasol./Gas (LPG)	FWD	1229	59	80	09.09-08.14	*
1.2 LPG		Gasol./Gas (LPG)	FWD	1229	61	83	06.11-08.14	*
1.2 LPG		Gasol./Gas (LPG)	FWD	1229	61	83	06.11-08.14	*
1.2 LPG (L08) (A 12 XER)		Gasol./Gas (LPG)	FWD	1229	63	86	08.11-08.14	*
1.2 LPG (L08) (A 12 XER)		Gasol./Gas (LPG)	FWD	1229	63	86	08.11-08.14	*
1.4 LPG (L08) (Z 14 XEP)		Gasol./Gas (LPG)	FWD	1364	66	90	07.06-08.14	*
1.4 LPG (L08) (Z 14 XEP)		Gasol./Gas (LPG)	FWD	1364	66	90	07.06-08.14	*
1.4 LPG		Gasol./Gas (LPG)	FWD	1398	64	87	09.09-08.14	*
1.4 LPG		Gasol./Gas (LPG)	FWD	1398	64	87	09.09-08.14	*