

LISTA DE APLICACIONES - BUYERS GUIDE

3R15269020

Weight: 8.698

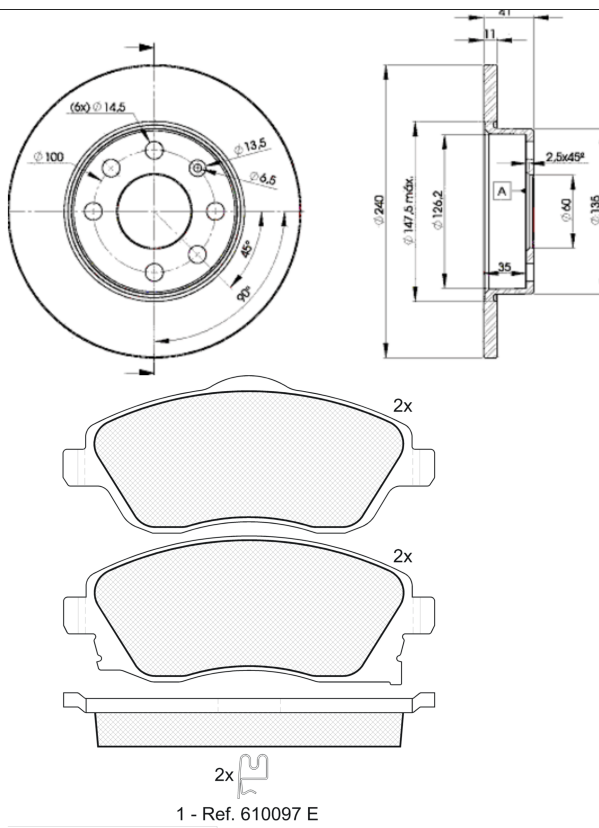

181526-701



3R15269020



Lucas - Girling

131.5x52.5x17

Ø240x11x41

WVA

23225

Sin Filas



Trac.

CC

Kw

CV



Front / Rear

OPEL

CORSA C (X01) 09.00-

Furgón/hatchback (LCVs-N1 Segment)

1.2 (F08, W5L) (Z 12 XEP)

Gasolina

FWD

1229

59

80

07.05-06.06

*

1.2 (F08, W5L) (Z 12 XEP)

Gasolina

FWD

1229

59

80

07.05-06.06

*

CORSA C / VITA C (X01) 09.00-12.09

[CAMBIADO]:Fastback (Supermini car-B Segment)

1.0 (F08, F68) (Z 10 XEP)

Gasolina

FWD

998

44

60

06.03-12.09

*

1.0 (F08, F68) (Z 10 XEP)

Gasolina

FWD

998

44

60

06.03-12.09

*

1.2 Twinport (F08, F68) (Z 12 XEP)

Gasolina

FWD

1229

59

80

07.04-12.09

*

1.2 Twinport (F08, F68) (Z 12 XEP)

Gasolina

FWD

1229

59

80

07.04-12.09

*

VAUXHALL

CORSA Mk II (C) (X01) 08.00-04.07

[CAMBIADO]:Fastback (Supermini car-B Segment)

1.0 12V (F08, F68) (Z 10 XEP)

Gasolina

FWD

998

44

60

11.03-10.06

*

1.0 12V (F08, F68) (Z 10 XEP)

Gasolina

FWD

998

44

60

11.03-10.06

*

1.2 16V Dualfuel (F08) (Z 12 XE)

Gasol./G
as (LPG)

FWD

1199

55

75

08.01-10.06

*

1.2 16V Dualfuel (F08) (Z 12 XE)

Gasol./G
as (LPG)

FWD

1199

55

75

08.01-10.06

*

CORSAVAN Mk II (C) (X01) 09.00-11.06

Furgón/hatchback (LCVs-N1 Segment)

1.2 16V Dualfuel (F08) (Z 12 XE)

Gasol./G
as (LPG)

FWD

1199

55

75

08.01-06.06

*

1.2 16V Dualfuel (F08) (Z 12 XE)

Gasol./G
as (LPG)

FWD

1199

55

75

08.01-06.06

*